

UMBRA®MOTORISATION

Somfy WT Motor

Switch Control



UMBRA®

UMBRA®
somfy®

WT control Options

Wall Switch

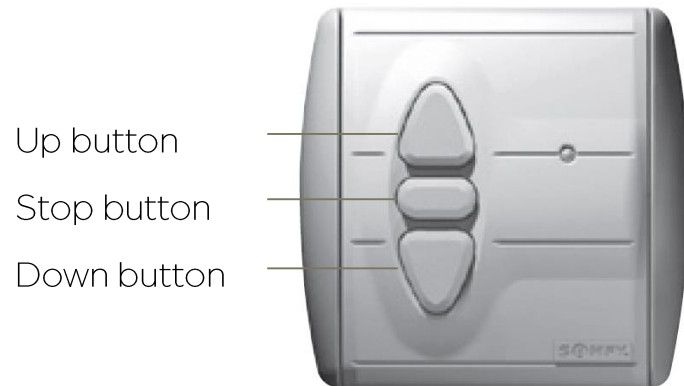

A wall switch may be connected directly to a single blind but wiring multiple Somfy WT blinds in parallel will result in damage to the motors

When group operation or home automation control is required a motor relay will be necessary

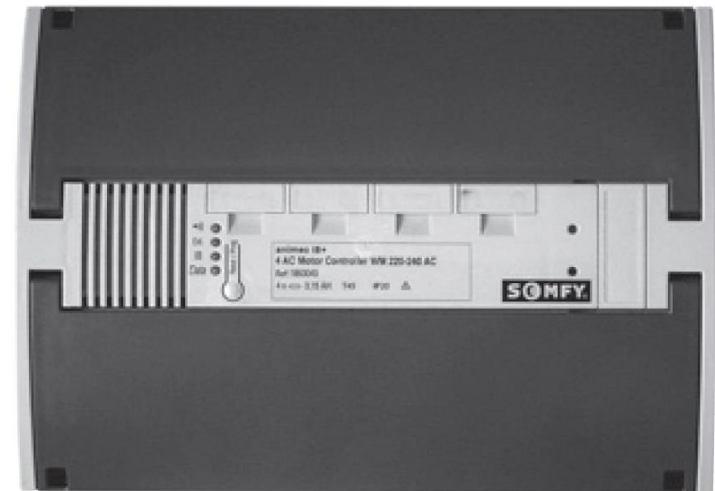

Motor Relay

Somfy WT 230v motor wiring

UMBRA®

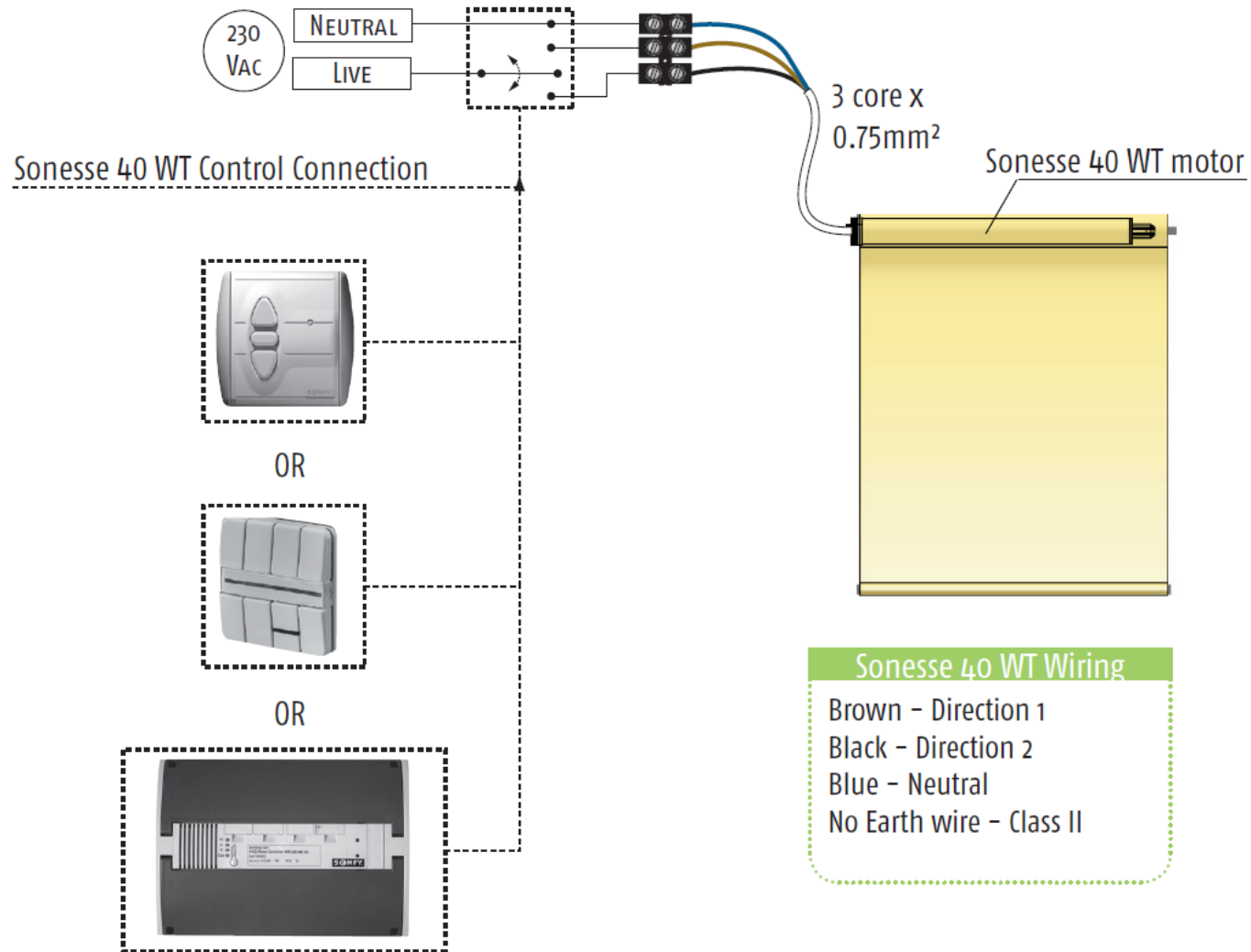

The Sonesse 40 motor range is Class II rated – no earth required

Somfy WT 230v for Home Automation

UMBRA®

Scenario based on 4 Sonesse 40 WT motors controlled by a home automation device.

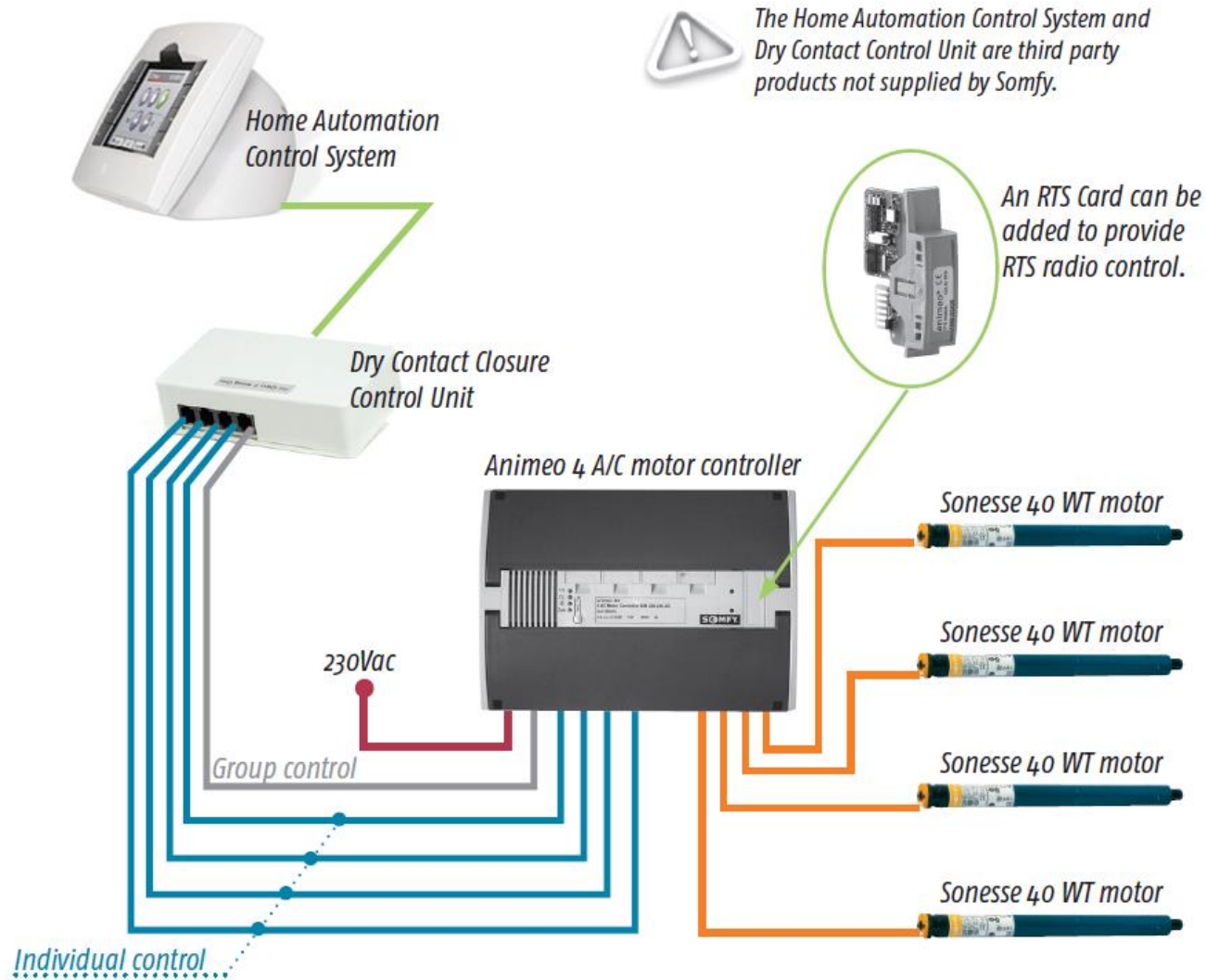

Before You Start – Important Information



To control more than one blind from a single switch you must use a motor relay. Wiring multiple Sonesse 40 WT's in parallel will result in damage to the motor.



Somfy motors do not have replaceable cables so take care when reducing the length.

Do not use an electrical tool to adjust the limit positions

The motor should be moved away from the stop position before limits are altered

Changing Turning Direction

Check and change the turning direction of the motor

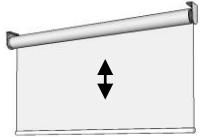

Connect a switch or setup tool and press and hold the ▼ button and observe the direction the blind travels.

It could travel in either direction depending on which side the motor is on

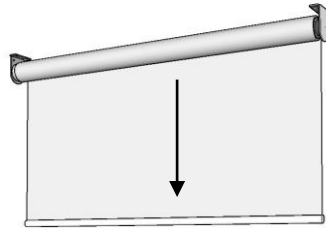

If the blind travels DOWN when you press the ▼ button you can skip the rest of this page and move straight on to setting the limits

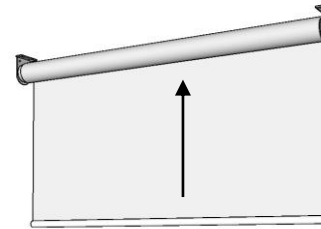

If the blind travels UP when you press the ▼ button you need to change the turning direction

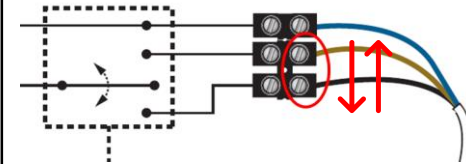

Swap the black and brown cores around on the connection between the motor and the switch

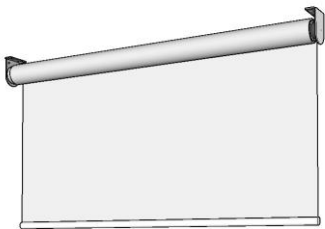

Turning direction changed



You can now check the turning direction is correct by pressing and holding EITHER the ▲ or ▼ button

The motor is still in programming mode so you have to press and hold to drive the blind

Setting/Adjusting Limits

Limits are always set on the Somfy WT motor – you just need to adjust them to suit your window

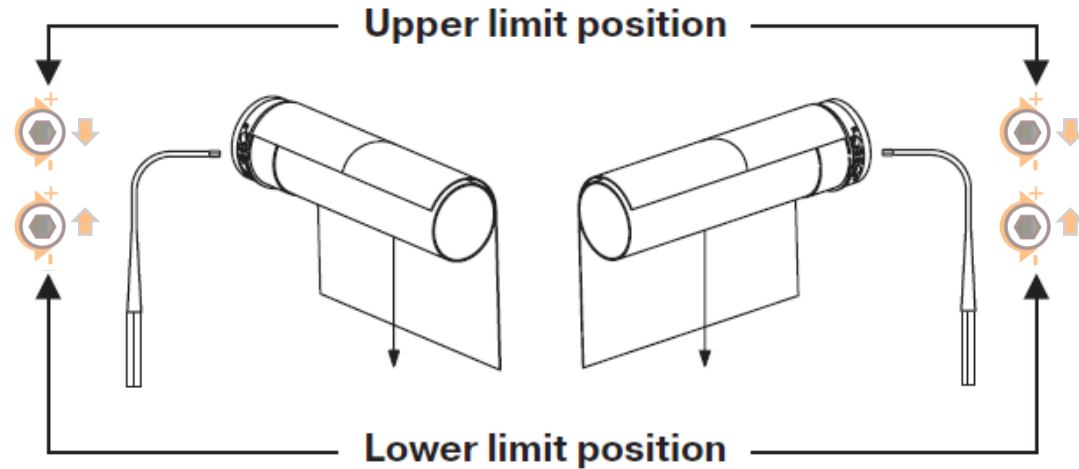

The position of the motor, to the right or left, and the way the fabric is rolled on the tube, impacts how to set the limits

Turning towards the + on either screw moves the limit further away from opposite limit.

For example, turning the Upper Limit Screw towards the + will move the top limit towards the tube

Therefore turning the Lower Limit Screw towards the + will move the bottom limit away from the tube

i.e. if the limit is beyond the top of the blind you need to turn the Upper Limit Screw towards the – to bring the limit back.

Do not use an electrical tool to adjust the limit positions

The motor should be moved away from the stop position before limits are altered

