

& CASCADE™

MOTORISED ROMAN BLIND SYSTEM



# & CASCADE™

## MOTORISED ROMAN BLIND SYSTEM

Roman blinds are a soft and elegant window dressing. Luxurious yet highly practical. Cascade™ motorised roman headrails enhance these benefits to a whole new level.

### OVERVIEW

- Quiet motion with high performance
- 5 year warranty
- Capable for blinds up to 16m<sup>2</sup> or 26kg
- Choice of wired or wireless motors



### SYSTEM DETAILS

The Cascade™ system comprises a powder-coated aluminium headrail, containing a motorised tubular steel drive with nylon cord spools. The result is a strong and robust headrail which can lift even the largest roman blinds effortlessly and quietly.

Universal steel snap-in brackets offer top-fix or face-fix options, ensuring that installation is always simple and secure.

The wide choice of motors includes 240V, 24V or battery powered. They can be controlled via hardwired or dry contact switching, or radio remote control. Integration with smart-home and building management systems is readily achievable.

### USES & APPLICATIONS

Roman blinds are a popular choice of window dressing, with good reason. They combine the benefits of curtains and blinds into one beautiful and functional product. Cascade™ motorised headrails provide added convenience, safety, and sophistication.

Operate your blinds from anywhere with ease; schedule automatic opening or closing; integrate with lighting and other elements to create favourite scenes. The possibilities are endless.

Removal of the hanging cords or chains from traditional manual headrails means that Cascade™ roman blinds are completely child-safe.

With no need to handle your blinds to operate them manually, plus a 5 year warranty, Cascade™ motorised headrails will keep your roman blinds looking their best for years to come.

This system is ideal for residential or hospitality applications.



MOTOR OPTIONS



240v, 24v or battery powered



Hardwired switch



Radio remote control



Dry contact or digital controls



Min & Max Sizes:  
360mm – 4000mm Width  
Up to 4000mm Drop

SYSTEM SPECIFICATION

System Dimensions

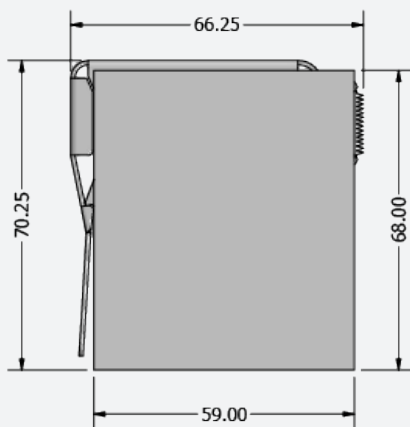

Headrail Size	No. of Cord Spools
Up to 699mm	2
700mm - 1099mm	3
1100mm - 1399mm	4
1400mm - 1699mm	5
1700mm - 2099mm	6
2100mm - 2399mm	7
2400mm - 2699mm	8
2700mm - 3099mm	9
3100mm - 3399mm	10
3400mm - 3699mm	11
3700mm - 4000mm	12

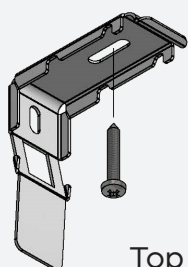

Top fix

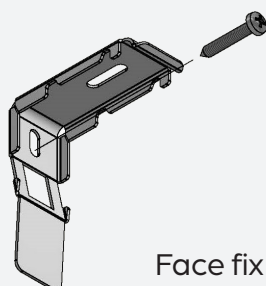

Face fix

# UMBRA®YOU

## BLIND SYSTEMS

See Systems Overview brochure for more information

ROOFLIGHT SYSTEMS

BLACKOUT SYSTEMS →

SQUARE AREA

18m<sup>2</sup>

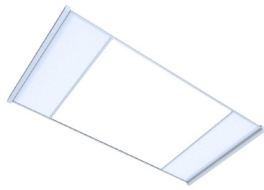

® KUROLOK™  
TWIN RL

9m<sup>2</sup>



® KUROLOK™  
RL

4m<sup>2</sup>

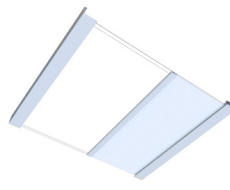

® HELIOS™  
RL

24m<sup>2</sup>



® KUROLOK™

BLACKOUT SYSTEMS

ROLLER SHADES →

14m<sup>2</sup>



® KURO™

LARGE

16m<sup>2</sup>



® HELIOS™

MEDIUM

6m<sup>2</sup>



® SIRIOS™

SMALL

3m<sup>2</sup>



® ORBIS™

FIND OUT MORE

FOR MORE SYSTEM INFO AND AUTOMATION  
OPTIONS VISIT

[www.umbrashading.co.uk/tools/product-selector-guide](http://www.umbrashading.co.uk/tools/product-selector-guide)

UMBRA®

In line with our policy of continuous product development, we reserve the right to alter specifications without notice.

01792 562015  
sales@umbrashading.co.uk  
www.umbrashading.co.uk