

THE POSSIBLE ZONE

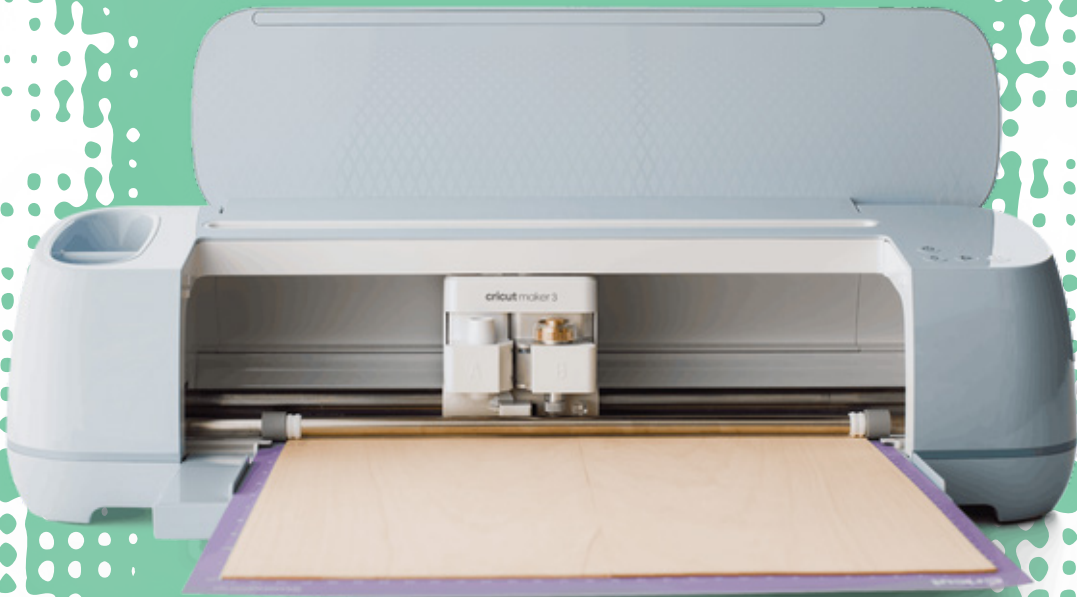

Cricut

THIS GUIDE IS NOT A
SUBSTITUTE FOR TRAINING OR
FOR THE USER MANUAL. THIS
GUIDE SERVES AS A REFRESHER
ONLY. USERS MUST BE
CERTIFIED TO USE EQUIPMENT
INDEPENDENTLY.



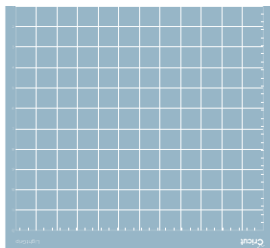
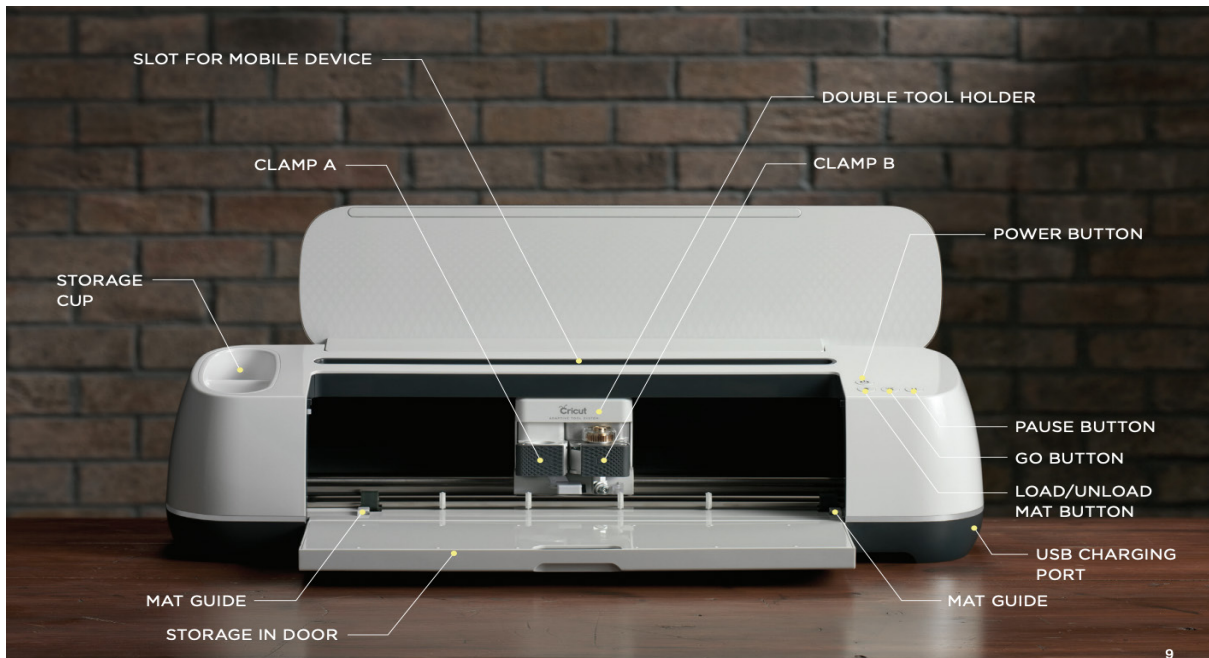

LightGrip™ Mat

Great for lighter-weight materials with soft-release adhesive for easier cut removal.

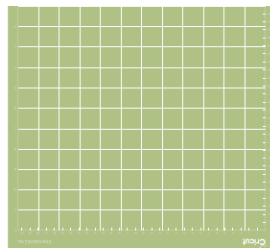

StandardGrip™ Mat

This versatile mat works with a wide range of light- to medium-weight materials.

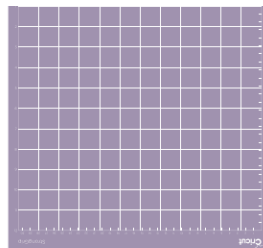

StrongGrip™ Mat

Ideal for thick, stiff materials requiring high cut pressure, like chipboard, balsa, and matboard.

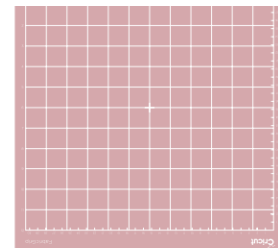

FabricGrip™ Mat

Use with most fabrics including cotton, polyester, denim, felt, and canvas.

THIS TOOL IS PRIMARILY FOR:

VINYL CUTTING

SUPPORTED FILE TYPES:
SVG, DXF

MAKING STICKERS

SUPPORTED FILE TYPES:
JPG, PNG, GIF, HEIC & BMP

MATERIALS

- + Fabric
- + Paper
- + Card stock
- + Cardboard
- + Vinyl
- + Veneer
- + Sticker paper
- + Smart Material : Smart Materials are the only materials designed by Cricut to work without a mat, so you can just load the material directly into the Cricut



Please Note!

Cricut smart cutting machines are **not food safe**, and cannot cut fondant or similar materials.

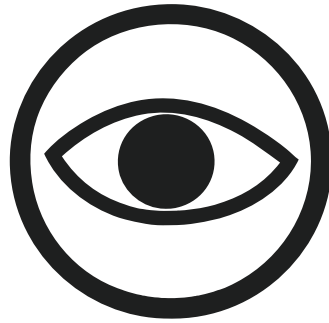

- Do not leave the Cricut unattended.
- Keep an eye on your job. When jobs are running, stay by the machine

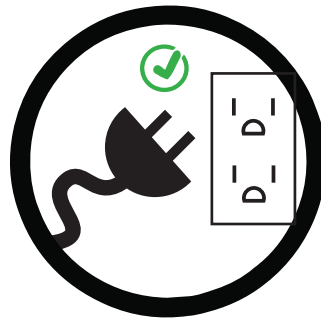

Protect your hands

- Don't touch hot surfaces: Heat Press/ Cricut Mug Press
- No hands on the Cricut when the machine is moving
- Ask a staff member for help with changing out blades or other tools. Make sure to turn off and unplug machine before changing blades/ tools.

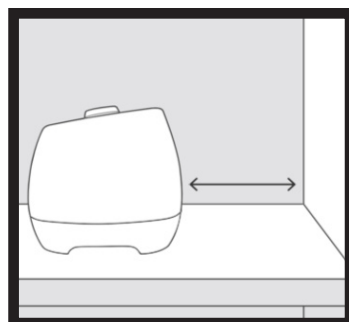

- No forcing the material in or out of the Cricut
- Make sure to have space behind the Cricut when operating

This documentation covers basic steps on how to set up the Maker 3 Cricut for cutting out a sticker.

Reminder that this documentation does not take the place of training as is ment to be a refresher.

For the full documentation on making stickers with the Cricut scan the QR code

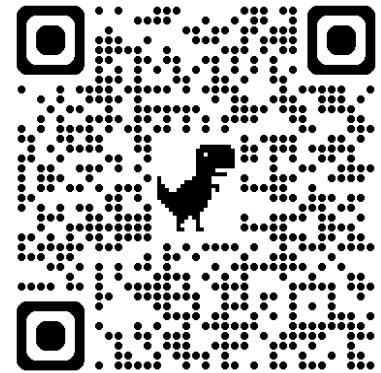

CRICUT DESIGN SPACE

- Open up or download the Cricut Design Space software.
- Click the green new project button in the top right corner.
- In the tools bar to the bottom left, select the upload button to upload the creation you want to cut into the canvas.
- In that new page, click the upload image button
- Drag and drop your creation or browse your computer to upload the creation you want to use.

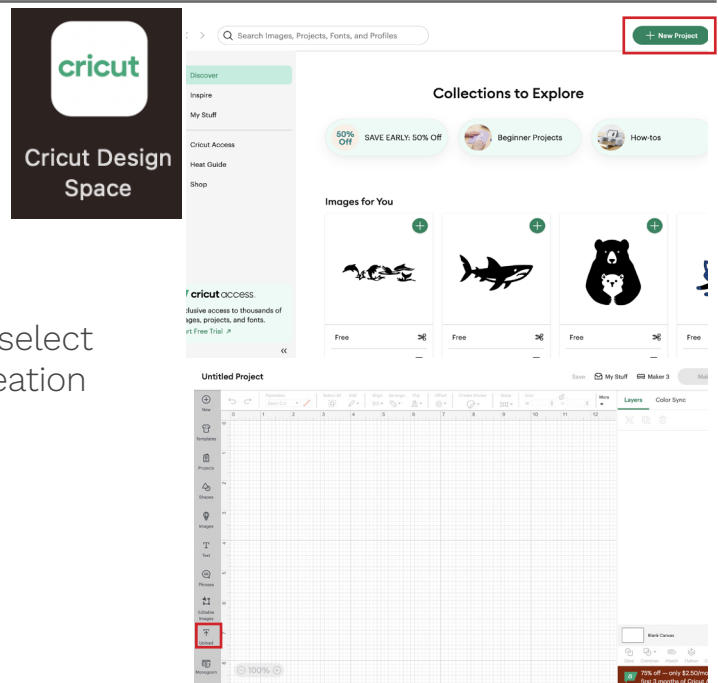

SET UP FILE

- Next step delete the background of your image.
- On the next page is “**Convert Upload To**”. Scroll down and select **Flat Graphic** then click the green continue button in the bottom right.
- Next name your image and select what collection you want to save your image in, if any. When you are done, click the green upload button in the bottom right.

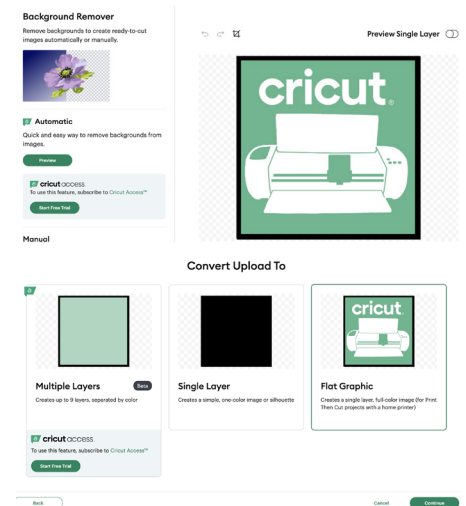

SET UP STICKER

- Click the create sticker button in the top middle right
- You will have to choose what kind of sticker you want to have.
 1. Die Cut: If you want the sticker to fully cut out of the paper.
 2. Kiss Cut: If you want the sticker to be able to be peeled off of the sticker sheet
- When you are ready to print your sticker, make sure **Maker 3 is selected** in the top right corner and then click the green make button in the top right corner.
- Select printer you are using. Insert 8.5” x 11” sticker paper with the shiny side up into the printer and hit send.

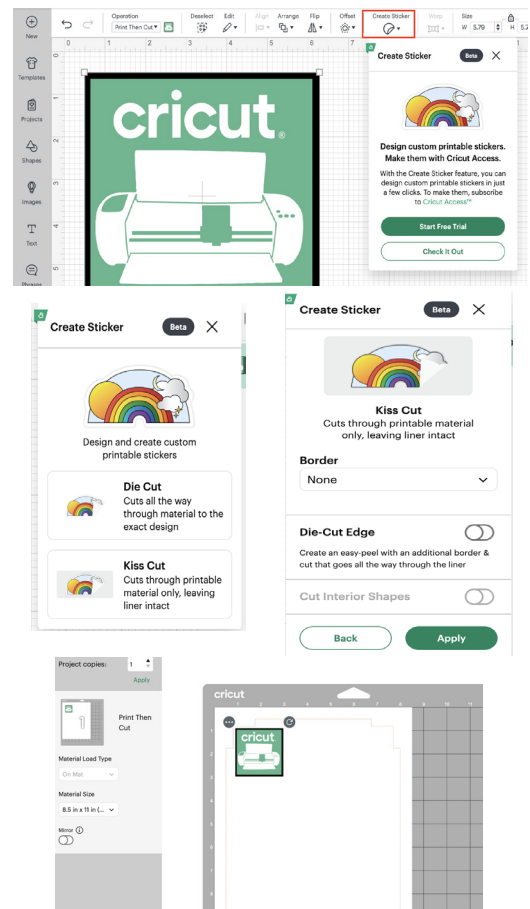

SET UP CRICUT

- Connect the usb of the Cricut to your computer.
- Select sticker paper for your material and place on green mat.
- When ready, press the blinking **insert** button.
- To start the job, click the blinking **Go** button.
- When finished press the **insert** button again to retrieve the mat.
- Make sure to put back plastic cover on mat when finished!



MAKE SURE THERE IS SPACE BEHIND THE CRICUT!



SET UP CONFIRMATION

USE THE FOLLOWING CHECK LIST TO INSURE THAT YOU HAVE SET UP THE MACHINE SAFELY AND PROPERLY.

THIS GUIDE IS NOT A SUBSTITUTE FOR TRAINING OR FOR THE USER MANUAL. THIS GUIDE SERVES AS A REFRESHER ONLY. USERS MUST BE CERTIFIED TO USE EQUIPMENT INDEPENDENTLY.

SELF CHECK

- You're using supported materials.
- You are using the correct mat for the job.
- Reminder that Smart Materials are the only materials that can be used without a mat
- That there is enough space behind the cricut.
- Making sure not to touch the cricut when in motion.
- Unplug the machine if changing out blades/parts.
- If you are cutting a shape on top of another shape, such as text in a name tag, make sure to select all the shapes and attach them.
- Keep watch over your project while the job is running.
- Reminder that Cricut is not food safe.

CLEAN UP

- Remove project from the mat.
- All loose and scrap materials are tossed.
- The mat's plastic cover is put back on the mat when finished.
- All Cricut components are stored in their bins and put away.

This Machine Training Curriculum derives from the framework developed by Autodesk Pier 9 and posted on www.instructables.com/pier9/ Many thanks to the wonderful people of AutoDesk Pier 9.