

DTG



THE POSSIBLE ZONE



DTG

THIS GUIDE IS NOT A
SUBSTITUTE FOR TRAINING OR
FOR THE USER MANUAL. THIS
GUIDE SERVES AS A REFRESHER
ONLY. USERS MUST BE
CERTIFIED TO USE EQUIPMENT
INDEPENDENTLY.



last modified: January 15, 2025 12:39 PM.

- 1. Front Cover:** Open this cover when cleaning the internal area of the printer. (STEAM TEAM ONLY)
- 2. Carriage:** Holds the print head.
- 3. Obstacle sensor & Platen too low sensor:** Checks the presence of any obstacles by their height (such as wrinkled T-shirt) that are within range to collide with the print head. Make sure that the clearance between the head and platen is not too large.
- 4. Platen sheet:** It helps to keep the T-shirt from moving/shifting during printing so that an image can be clearly printed.
- 5. Platen:** Where you set the T-shirt to be printed.
- 6. Shoulder bar:** Align the position of a T-shirt with this bar.
- 7. T-shirt tray:** This T-shirt tray holds such portions of T-shirt that droop down on it and feeds the entire T-shirt into the printer.
- 8. Operation panel:** Operate the printer using this panel.

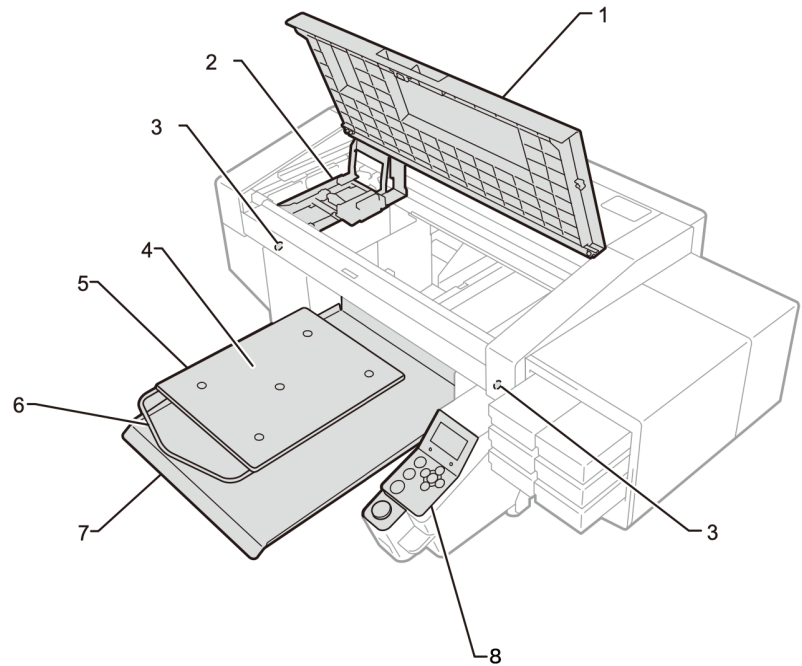

THIS TOOL IS PRIMARILY FOR:

PRINTING GRAPHICS DIRECTLY ON FABRIC

SOFTWARE = ACCULINE CAMERA SYSTEM

SUPPORTED FILE FORMATS:

PNG, JPEG (JPG), TIFF, BMP & GIF

PNG IS THE BEST FILE FORMAT FOR PRINTING AS PNGS SAVE LAYER INFORMATION AND TRANSPARENCY

MATERIALS

- + 100% Cotton shirts
- + 100% Polyester (suggested CMYK ink only)
- + Untreated Canvas
- + Various Blends (At least 50% cotton)
- + Denim
- + Untreated Leather
- + Silk

UNSUPPORTED

- + Water repellent materials
- + Any splash resistant or coated material
- + Fleece type materials
- + Non-porous non-absorbent items
- + Plastics
- + Metals

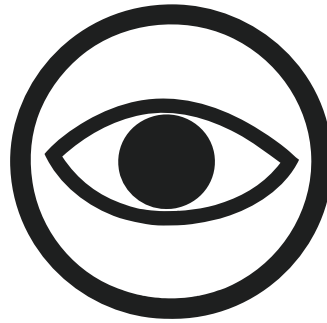

- Don't leave DTG or Heat Press unattended.
- When using the Heat Press be aware of the fabric/substrate you are using, many fabrics/substrates can melt under high heat.

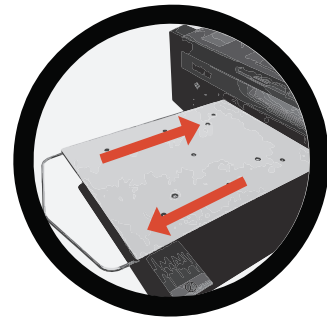

Caution

- Ensure there is adequate space left in front of the printer.
- Keep your body at a distance from the moving platen
- Make sure no hands are on the plate or on hot surfaces on the Heat Press.

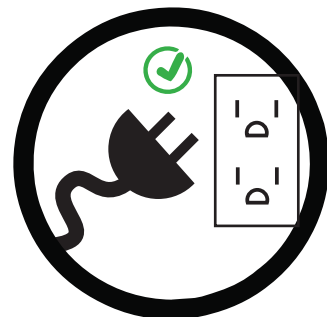

- **DTG stays on.** Make sure not to turn off the machine.
- Make sure there are no liquids near or on the machine
- **If liquid spills** on the machine immediately stop the print, turn off the power, **disconnect the power cord** and talk to a qualified S-team tech.

This documentation covers basic steps on how to set up the DTG to print on a white T-Shirt .

Reminder that this documentation does not take the place of training, as is meant to be a refresher.

For the full documentation or for instructions on how to you the pretreat machine for dark materials head to the QR code

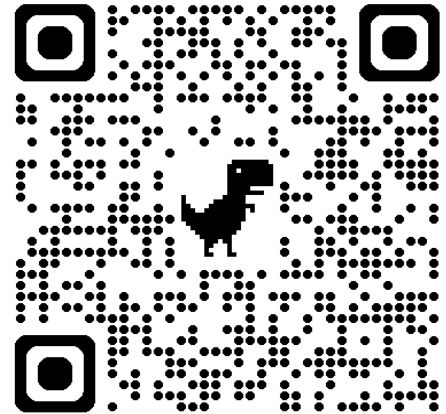

PREPARATION

- Turn on the Heat Press to allow it to get to temperature
- If prompted, gently shake the two white ink cartridges for 60secs
- Then preform a test print the white and color inks on transparent or white paper
- When finished, place white T Shirt on platen so that the shoulder bar is inside of the shirt like a hanger



Import & Arranging Art work

- Head to the DTG PC
- In Acculine hit the camera Icon to take a photo of the platen/ T shirt
- Import your artwork by dragging and dropping into acculine
- Arrange artwork to desired position on the shirt.

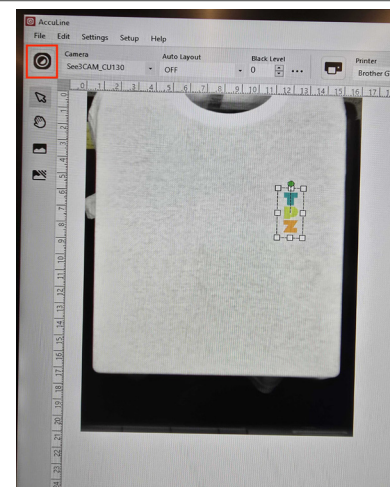

Print

- Head to Settings
- For white/ light garments choose “Color Ink Only” Or “Black Ink Only” (No White Ink is needed)
- Hit print button
- The chime and lit green button indicates the file was successfully sent to the DTG and ready to print.
- Push green button to send job.

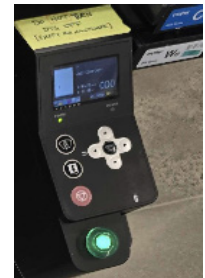
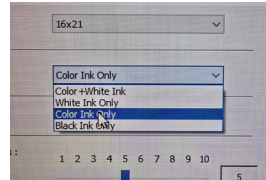
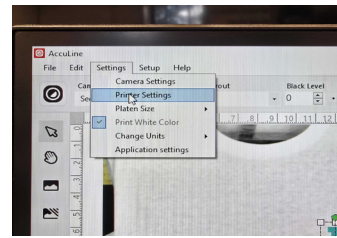

KEEP DISTANCE FROM MOVING PLATEN

Common Errors and their fixes:

If you get the “Obstacle in the Way” error message that means the fabric/garment/ substrate is not laying flat or platen bed too high

If you get “Platen too low” error message that means that the platen is too low and needs to be raised

Fix these by adjusting the height of the Platen

1. Loosen the platen fixing lever by rotating it one or two turns [right with red knob]
2. Rotate the Platen height adjustment lever [top lever] towards A for higher and H for lower
3. If more adjustments are needed ask a staff member



HEAT PRESS

- Once the print is finished use the heat press to dry and cure/ set your design on the fabric
- Make sure to keep fabric flat when transporting fresh designs. Designs can smudge before using the heat press.
- Heat Press the printed garment/fabric at 325°-350°F for 35 secs to cure ink



KEEP HANDS AWAY FROM HOT HEAT PRESS



SET UP CONFIRMATION

USE THE FOLLOWING CHECK LIST TO INSURE THAT YOU HAVE SET UP THE MACHINE SAFELY AND PROPERLY.

THIS GUIDE IS NOT A SUBSTITUTE FOR TRAINING OR FOR THE USER MANUAL. THIS GUIDE SERVES AS A REFRESHER ONLY. USERS MUST BE CERTIFIED TO USE EQUIPMENT INDEPENDENTLY.

SELF CHECK

- Swipe in/ Sign in to DTG using Fabman
- Turn on Head Press first to allow time to warm up
- Check Printer Settings as the printer settings do not change from previous jobs (prints).
- Take a snapshot of the platen to make sure your design is placed in desired location
- Iron/Heat Press any wrinkles
- Stay clear of moving platen
- Heat Press after printing to cure ink

CLEAN UP

- You never turn off the machine unless explicitly told to do so in a maintenance process. Always keep the machine plugged in and powered on so it can circulate the ink.
- Turn off Heat Press
- Remove any extra fabric or supplies from the DTG area
- Sign out of DTG using Fabman bridge (x) button