



CELL IMPLANTS

# Content

Introduction .....	2-11
--------------------	------

## CELL IMPLANTS

Cell Implant .....	12-17
--------------------	-------

## SUPRASTRUCTURES

Premilled Abutments .....	20
---------------------------	----

Freeform Abutments .....	20
--------------------------	----

Titanium Base Conuses for Cerec Sirona .....	21
---	----

Titanium Platforms for CAD/CAM .....	22-23
---	-------

Plastic Burnout Abutments .....	26
---------------------------------	----

Angular Multi-units 17° / 30° .....	28-29
--	-------

Angulated multi units For multi-units 45° .....	30
--	----

Straight Multi-units .....	31
----------------------------	----

Sleeves .....	32
---------------	----

Titanium Abutments .....	33-37
--------------------------	-------

Locators .....	38-39
----------------	-------

Ball Attachments .....	40-41
------------------------	-------

## HEALING CAPS

Narrow conus healing caps .....	44
---------------------------------	----

Peek healing caps .....	44
-------------------------	----

Healing caps .....	46
--------------------	----

Extra wide healing caps .....	47-48
-------------------------------	-------

## TRANSFERS & ANALOGS FOR IMPLANTS. SCAN-ABUTMENTS

Scan-Abutments .....	52
----------------------	----

Digital Analogs .....	53
-----------------------	----

Transfers and Analogs .....	54-57
-----------------------------	-------

## INSTRUMENTS AND KITS

Wrenches .....	60-61
----------------	-------

Instruments .....	62-63
-------------------	-------

Drills .....	64-65
--------------	-------

Advances surgical kit .....	66-69
-----------------------------	-------



# Unique hybrid implant

Cell is a unique hybrid implant that combines strength in the upper part and a synthesized part with a trabecular structure and threads. Progressive technologies with a biological concept are aimed at the highest survival rate and primary stability







## INTRODUCTION

# Cell Implants Company

Cell brand is part of the German corporation Alpha Dent Implants GmbH. Based on the latest achievements of science and technology, the company was able to single out a separate direction for creating a unique product. Laser synthesis technology allows to achieve results that are impossible to do with traditional CNC technologies. At the same time, the combination of two technologies allows you to get a reliable and durable result in tandem with the biological integration of a trabecular printed structure.

Production technology is verified and produced in accordance with ISO 13485 standards.

## INTRODUCTION

# Cell Implant

Base packing include:

- one box for all items
- implant in tube container
- product certificate cover screw
- warranty certificate

## Conventional signs







## INTRODUCTION

# ABOUT PRODUCT

## Sterility

All production of Cell Implants is thoroughly sterilized. Double sterile packing ensures sterility maintenance. Due to a high technical level of production and the strictest control of sterility, Cell Implants meets the requirements of the highest quality standards, confirmed by appropriate certificates.



## Positioning of the implant in bone

The distance between an implant and a tooth root must be minimum 1.5 mm, i.e. the distance from the implant site center to the next tooth must be about the diameter of the implant's body + 1.5 mm.

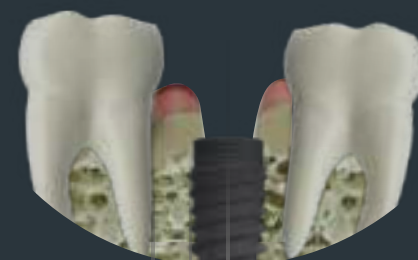

1.5 mm

Distance between the implant and  
tooth root



## LS-H 3D active surface

LS-H 3D Active surface represents the latest generation of dental implant surface treatment technology. This surface is active and hydrophilic; it has distinct multi-layered microporous structure. The thickness of oxide layer of the implant surface reaches 10-12 microns. Deepnest of the trabecular cell is 0,6mm. The entire thickness of the oxide layer is imbued with micropores that combine with each other and create a multilayered surface. This way, the bone tissue grows deeper both in and between micro pores. Thereby, implant surface area is significantly increased and, thus, the contact between bone tissue and implant surface is strengthened. Titanium oxide film is enriched with calcium hydroxyapatite, and the implant surface is contaminant-free. It has prominent hydrophilic characteristics (absorption).

Researches show that LS-H 3D Active surface stimulates active bone growth over the implant surface that results in mechanical stability. This surface property allows performing orthopedic rehabilitation at an earlier stage and significantly reduces the risk when the implant is installed under the one-stage procedure.

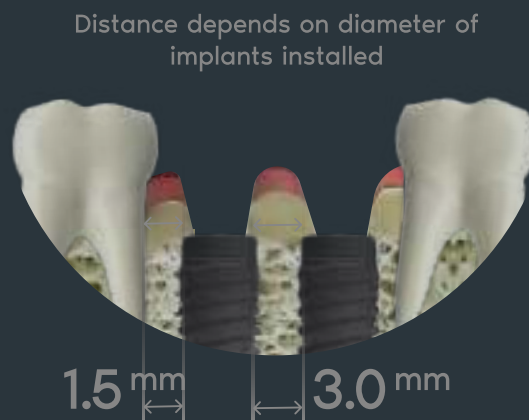

INTRODUCTION

# WORKSHOPS & TRAINING

## Cell Community

Cell Implants also conducts various educational programs, which meet the needs of experienced implantology specialists and beginner dentists of general practice. The company participates in charitable events, organizes tremendous off-site training activities all over the world, tours to factories, webinars, practical workshops.

For more information,  
please visit the official  
website of Cell Implants:

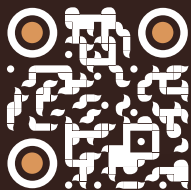

[www.cell-implants.com](http://www.cell-implants.com)



## Libraries for CAD/CAM



Exocad Libraries MC



Exocad Libraries



3Shape Libraries

For more information,  
please visit the e-  
catalogue of Cell Implants:

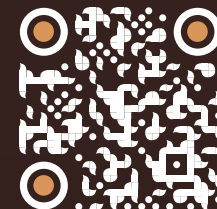







# cell

I M P L A N T S



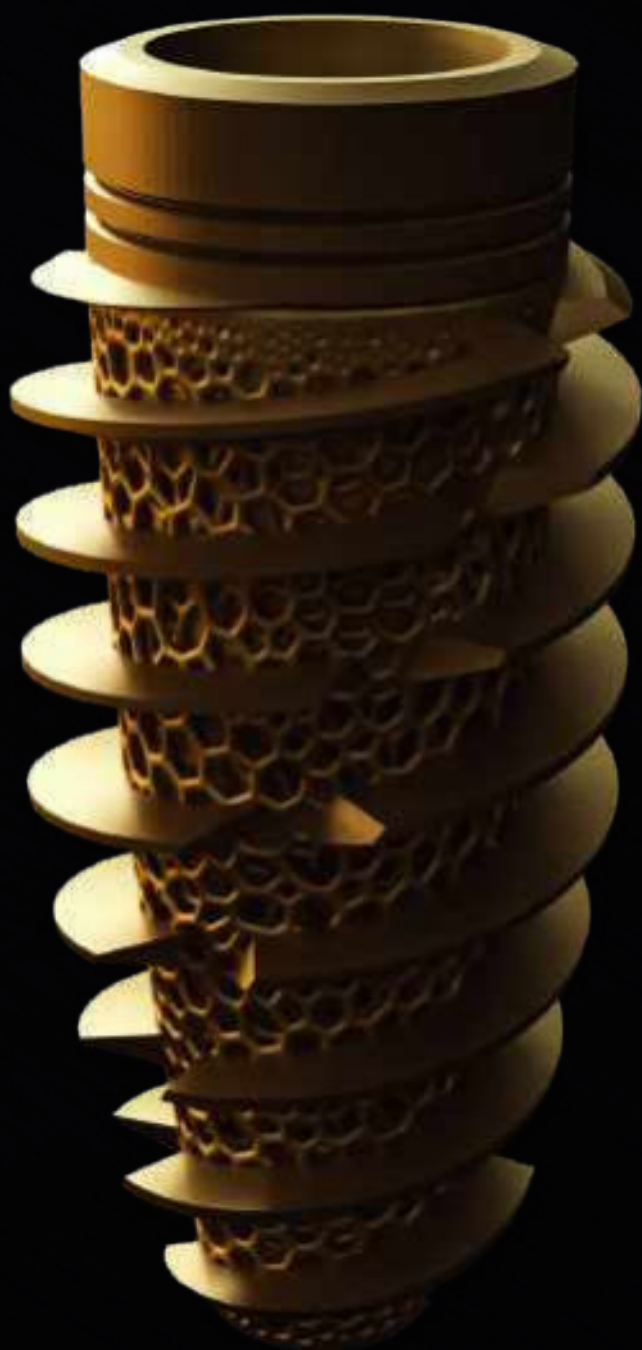

CELL FEATURES

# Luxuring confident

We have created qualitatively new **CELL implants** to reach a new level of osseointegration even in the most difficult clinical cases.

Using the most advanced additive technologies, we have managed to combine the trabecular structure and all-titanium thread, obtaining a **unique combined structure** that guarantees the most successful result of dental implantation!

Trabecular (spongy) structure of the **CELL implant** is achieved by dividing into cells by trabeculae - thick connecting bridges.

# Features of CELL Implants



Combined spongy structure of the entire implant, which is similar to the structure of the jawbone. Its advantages:

- Provides deeper bone ingrowth;
- Transmits chewing pressure like a living bone
- Allows the bone tissue to form full-fledged osteons in the thickness of the implant, thereby guaranteeing deep integration.



CELL has a high porosity. Surface roughness contributes to ultra-high primary fixation, due to maximum adhesion to bone tissue. The milled part of the implant, located in the middle, prevents untwisting under chewing load

10<sup>x</sup>

The surface area of the CELL implant is ten times larger than that of conventional implants of the same size! This ensures high-quality bone growth

G<sup>4</sup>

CELL implants are made of high quality Grade4 titanium, which has high biocompatibility, mechanical strength, osteoconductivity, corrosion resistance and excellent engraftment

FEATURES

# Cell Implant

## Structure

Multi-layer mesh structure imitates trabecular structure of the cancellous bone as accurately as possible

## Micro-thread

micro-rings to increase contact with the cortical plate

## Apical part

Rounding in the apical part prevents damage to Schneider's membrane

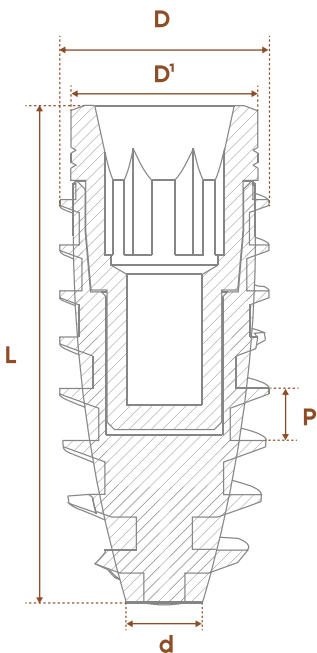

## Primary stability

Screw thread combination with the printed mesh structure provides excellent primary stability and osteointegration

## Micro-grooves

For improved contact with bone

## Monolithic titanium base

Monolithic titanium base made by milling method - for reliability, accuracy of the nozzle and stability under chewing load

## Anti-rotation groove

Prevents torsion

## Platform Switching



D	D1	d					p
3.85*	3.6	1.8	8	10	11.5	13	0.95
4.2	3.65	2.3	8	10	11.5	13	0.95
5.0	3.65	2.8	8	10	11.5	13	0.95

Table of sequential use of conical diamond like coated (DLC) drills for Cell Implant

Drill diameter, mm	1.5	2.0	2.8	3.0	3.45	3.9	4.7			
Drillingrate, RPM	D1 800-1200 D2 800-1200 D3 800-1000 D4 800-1000	D1 800-1000 D2 800-1000 D3 700-900 D4 600-800	D1 600-800 D2 600-800 D3 500-600 D4 400-500	D1 500-700 D2 600-800 D3 500-600 D4 400-500	D1 500-600 D2 500-700 D3 500-600 D4 400-500	D1 400-600 D2 500-700 D3 500-600 D4 400-500	D1 400-600 D2 400-700 D3 500-600 D4 400-500			
Implant diameter, mm	<div><div>16 mm</div><div>13 mm</div><div>11.5 mm</div><div>10 mm</div><div>8 mm</div><div>6 mm</div></div>					3.85	4.2	5.0		
Ø Drill	1.5	2.0	2.8	3.0	3.45	3.85	3.9	4.2	5.0	4.7
Drill marking	<div><div>no marking</div><div></div><div></div><div></div><div></div><div></div><div></div><div></div><div></div><div></div></div>									

\*Cortical bone drill for bone type I and II

Diamond like coated drills in Alpha Dent Implants system are developed with the aim to form a bone cavity for implants Active Bio because the drill shape recreates perfectly the shape of the implant without thread.







# SUPRASTRUCTURES FOR IMPLANTS

NARROW PLATFORM 2.1 MM (3.0)

# PREMILLED ABUTMENTS

Universal blank is 10 mm wide and 20 mm high.

- This type of individual abutment is produced on a high precision machine
- As a result, the creation of suprastructure with any diameter, height, shape, and angle is possible
- Blank is based on a conical platform, which provides the best implant-abutment connection for airtight fixation

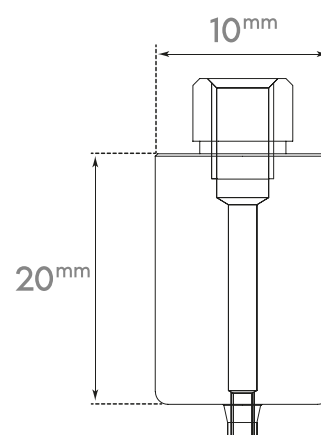

**Code:** PMAK3.0  
**Length:** 20 mm  
**Diameter:** 10 mm  
**Includes:** Retaining screw



NARROW PLATFORM 2.1 MM (3.0)

# FREEFORM ABUTMENTS

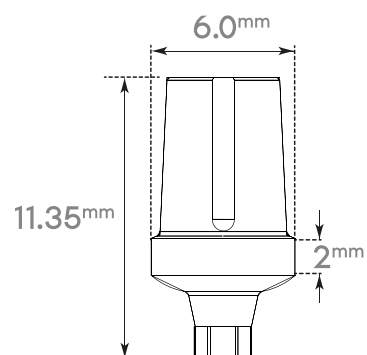

**Code:** FFA 3x2

**Code:** FFA 3x2  
**Length:** 11.35 mm  
**Diameter:** 6.0 mm  
**Length1** 2 mm



**Code:** FFA 3x5

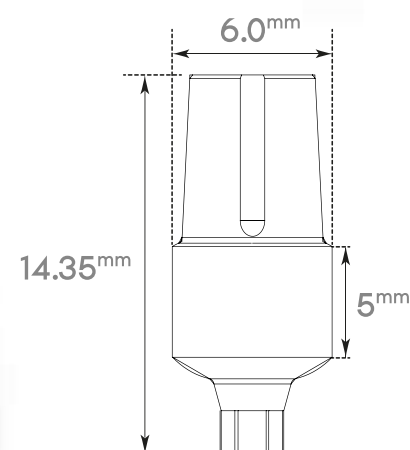

**Code:** FFA 3x5  
**Length:** 14.35 mm  
**Diameter:** 6.0 mm  
**Length1** 5 mm

FOR CEREC SIRONA / SMALL CONNECTION

# TITANIUM BASE CONUSES

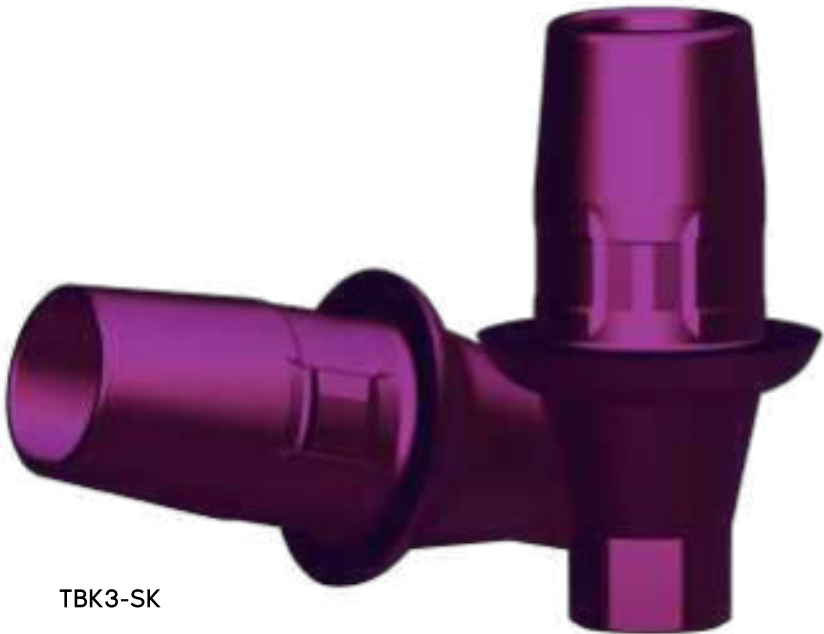

## NARROW CONICAL PLATFORM 2.1 MM (3.0)



**Code:** TBK3  
**Length:** 8.9 mm  
**Length1\*:** 1.8 mm  
**Diameter:** 3.4 mm  
**Includes:** Screw for the abutment

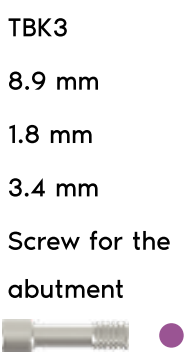

**Code:** TBK3-SK  
**Length:** 8.6 mm  
**Length1\*:** 4.3 mm  
**Diameter:** 1.5 mm  
**Diameter inside:** 3.3 mm  
**Includes:** Screw for the abutment



FOR CAD/CAM MU

# TITANIUM PLATFORMS

More information about a product you find there

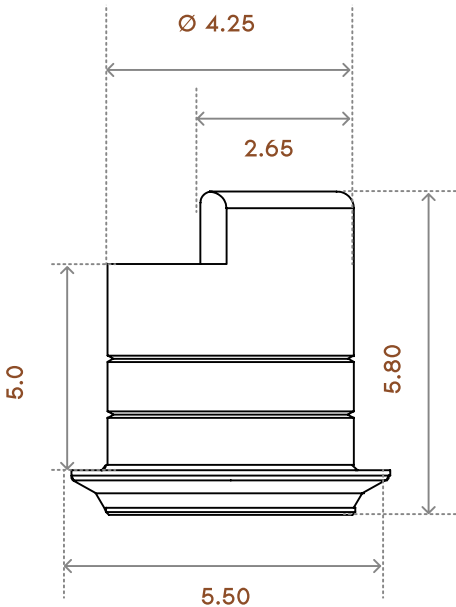
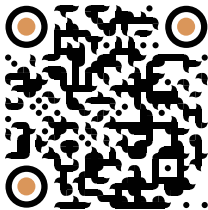

TPC-MU



# TITANIUM PLATFORM FOR CAD/CAM

Platform for CAD/CAM to produce individual structures using digital technologies.  
Unique occasion to choose a platform of different height depending on the type of mucosa.

## NARROW CONICAL PLATFORM 2.1 MM (3.0)



**Code:** TPCK3  
**Length:** 4.1 mm  
**Length1\*:** 1.5 mm  
**Diameter:** 4.6 mm  
**Diameter inside:** 3.3 mm  
**Includes:** Screw for the abutment

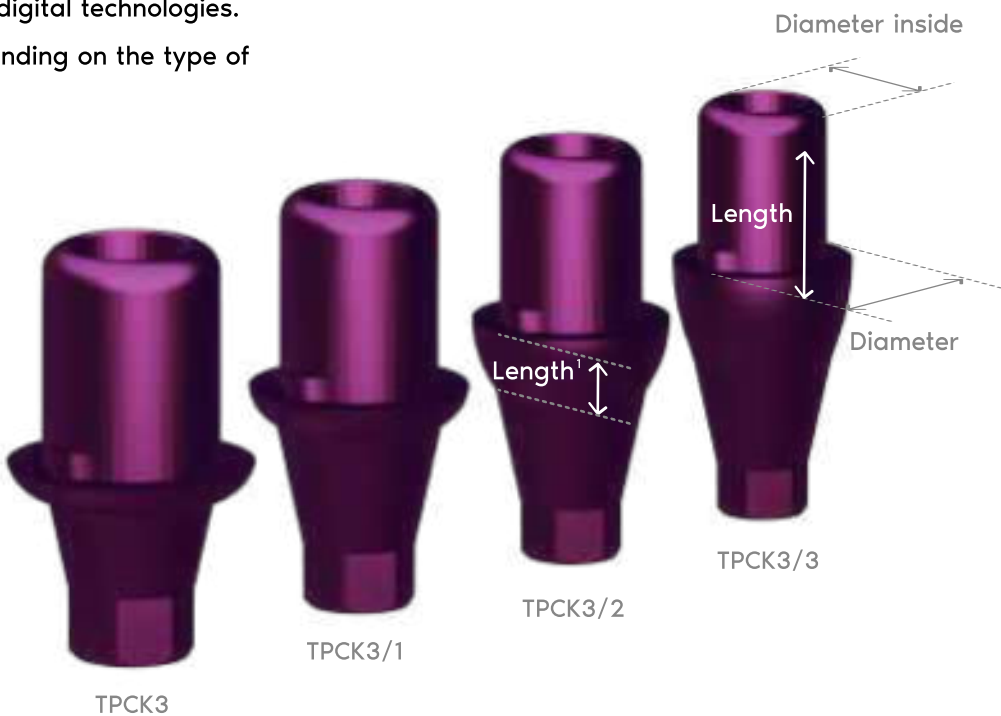

**Code:** TPCK3/1  
**Length:** 4.1 mm  
**Length1\*:** 2 mm  
**Diameter:** 4.6 mm  
**Diameter inside:** 3.3 mm  
**Includes:** Screw for the abutment



**Code:** TPCK3/2  
**Length:** 4.1 mm  
**Length1\*:** 3 mm  
**Diameter:** 4.6 mm  
**Diameter inside:** 3.3 mm  
**Includes:** Screw for the abutment



**Code:** TPCK3/3  
**Length:** 4.1 mm  
**Length1\*:** 4 mm  
**Diameter:** 4.6 mm  
**Diameter inside:** 3.3 mm  
**Includes:** Screw for the abutment



NON HEX NARROW CONICAL PLATFORM 2.1 MM (3.0)



**Code:** TPCK3-NH  
**Length:** 4.1 mm  
**Length1\*:** 1.5 mm  
**Diameter:** 4.6 mm  
**Diameter inside:** 3.3 mm  
**Includes:** Screw for the abutment



**Code:** TPCK3/1-NH  
**Length:** 4.1 mm  
**Length1\*:** 2 mm  
**Diameter:** 4.6 mm  
**Diameter inside:** 3.3 mm  
**Includes:** Screw for the abutment

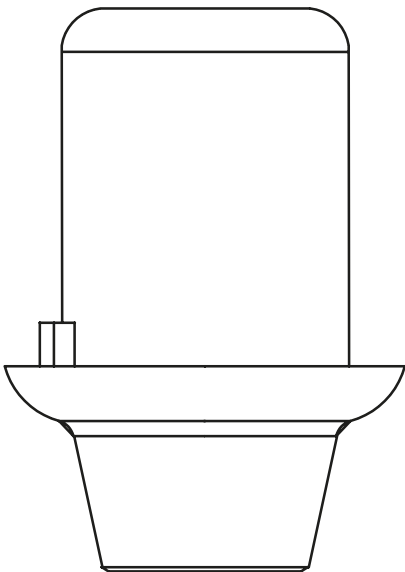

\*Indicator includes 1.0 mm of subcortical immersion.



**Code:** TPCK3/2-NH  
**Length:** 4.1 mm  
**Length1\*:** 3 mm  
**Diameter:** 4.6 mm  
**Diameter inside:** 3.3 mm  
**Includes:** Screw for the abutment



**Code:** TPCK3/3-NH  
**Length:** 4.1 mm  
**Length1\*:** 4 mm  
**Diameter:** 4.6 mm  
**Diameter inside:** 3.3 mm  
**Includes:** Screw for the abutment



More information about a product you find there

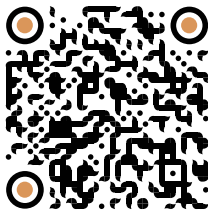



# Creating an orthopedic structure

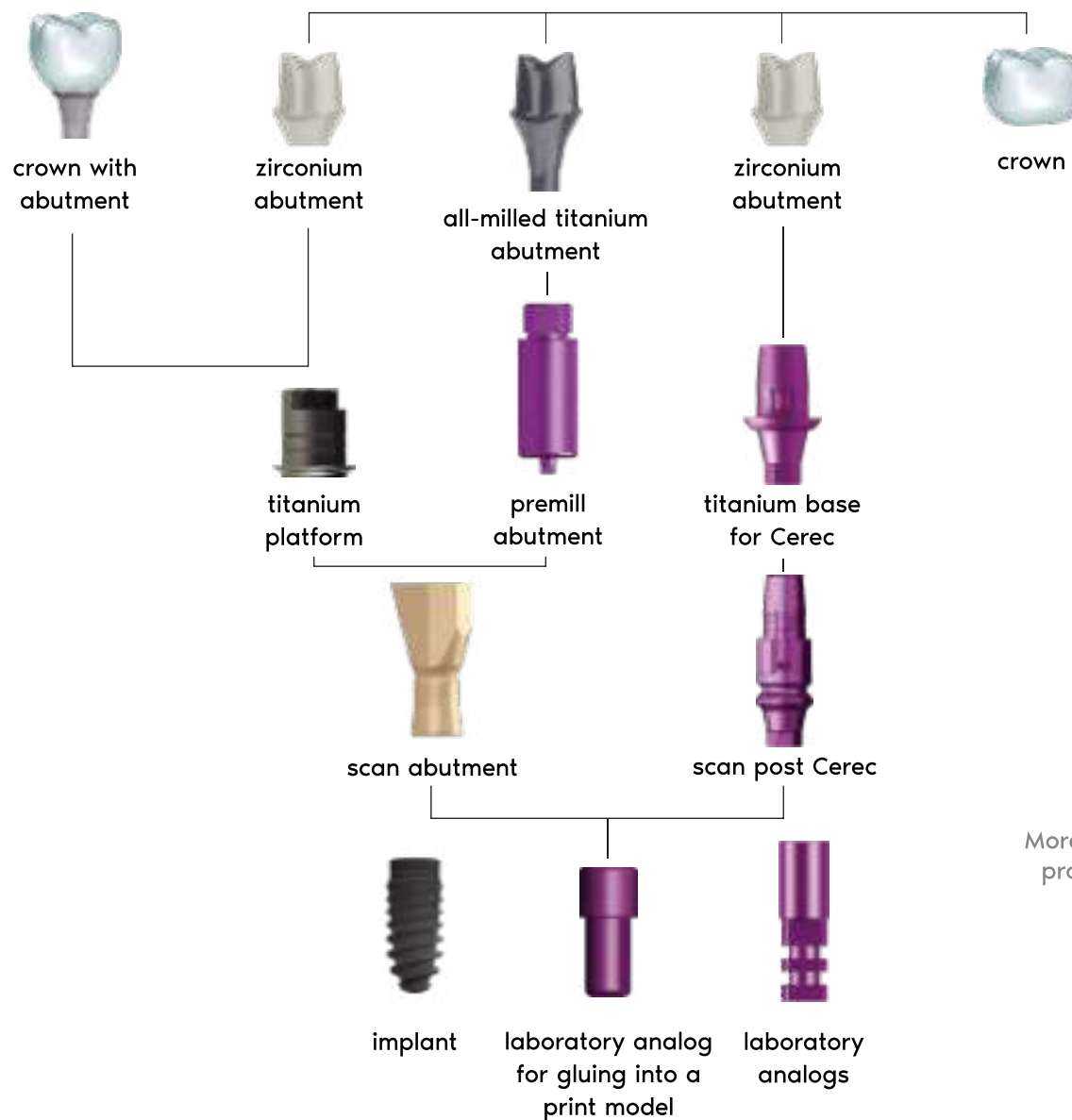

More information about a protocol you find there

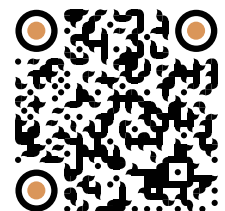

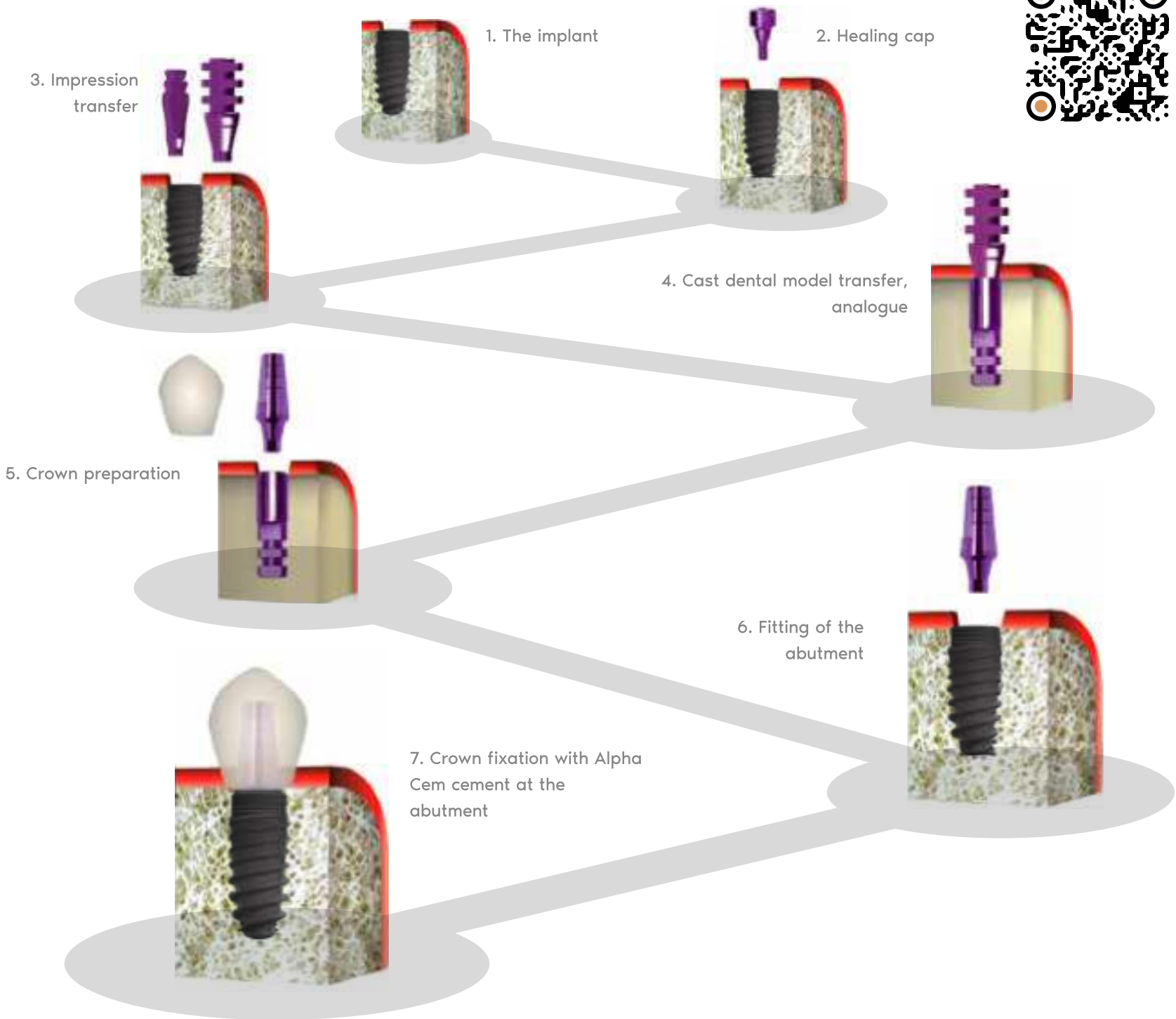
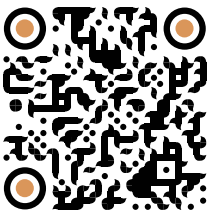

# PLASTIC BURNOUT ABUTMENTS

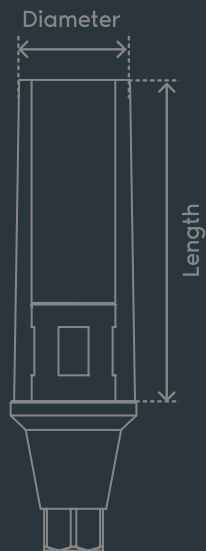

## TITANIUM-BASED NARROW CONICAL PLATFORM 2.1 MM (3.0)



**Code:** PTAK3  
**Length:** 9 mm  
**Length1\*:** 4.5 mm  
**Includes:** Screw for the abutment



More information about a product you find there

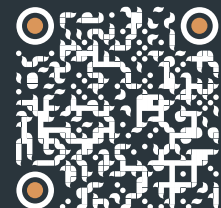

## NARROW CONICAL PLATFORM 2.1 MM (3.0)



**Code:** PAK3 NH  
**Length:** 9 mm  
**Length1\*:** 4.2 mm  
**Includes:** Screw for the abutment



# STRAIGHT ANTIROTATIONAL MULTI-UNITS



AEA3/003

AEA3/002

AEA3/001

Aesthetic antirotational abutment (straight multi-unit) with a plastic sleeve is used in order to restore a single structure or a bridge with a screw retention. Screw in with a maximum force of 20 newton.

\* Indicator includes 0.5 mm of subcortical immersion.



**CS AEA3**  
Cover Screw for Aesthetic Abutment

## NARROW CONICAL PLATFORM 2.1 MM (3.0)

<b>Code:</b>	AEA3/003
<b>Length:</b>	3.5 mm
<b>Length1*:</b>	4.7 mm
<b>Diameter:</b>	4.6 mm
<b>Diameter inside:</b>	2.1 mm
<b>Includes:</b>	Screw for the abutment



<b>Code:</b>	AEA3/002
<b>Length:</b>	2.5 mm
<b>Length1*:</b>	4.7 mm
<b>Diameter:</b>	4.6 mm
<b>Diameter inside:</b>	2.1 mm
<b>Includes:</b>	Screw for the abutment



<b>Code:</b>	AEA3/001
<b>Length:</b>	1.5 mm
<b>Length1*:</b>	4.7 mm
<b>Diameter:</b>	4.6 mm
<b>Diameter inside:</b>	2.1 mm
<b>Includes:</b>	Screw for the abutment



# ANGULAR MULTI-UNITS 17°

Multi-unit system is used for a prosthesis with screw retention. One-piece angular multi-unit allows rehabilitation at non-parallel implants by correcting the angle. Angular multi-unit is available in options 17° and 30° option.

\* Indicator includes 0.5 mm of subcortical immersion.



**Code:** MUBK3/1701  
**Length\*:** 1.5 mm  
**Diameter:** 4.3 mm  
**Angular:** 17°  
**Includes:** Screw for the abutment



**Code:** MUBK3/1702  
**Length\*:** 2.5 mm  
**Diameter:** 4.3 mm  
**Angular:** 17°  
**Includes:** Screw for the abutment



**Code:** MUBK3/1703  
**Length\*:** 3.5 mm  
**Diameter:** 4.3 mm  
**Angular:** 17°  
**Includes:** Screw for the abutment



MUBK3/1701



MUBK3/1702



MUBK3/1703

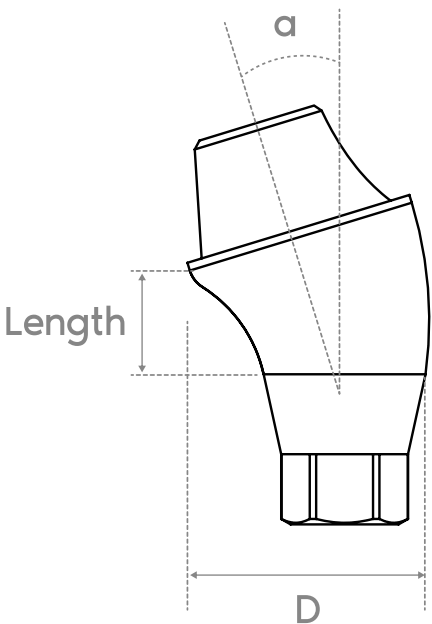



More information about a  
product you find there

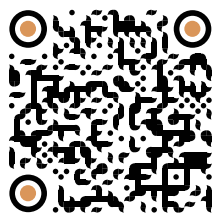

# ANGULAR MULTI-UNITS 30°



**Code:** MUBK3/3001  
**Length\*:** 1.5 mm  
**Diameter:** 4.7 mm  
**Angular:** 30°  
**Includes:** Screw for the  
abutment



**Code:** MUBK3/3002  
**Length\*:** 2.5 mm  
**Diameter:** 4.7 mm  
**Angular:** 30°  
**Includes:** Screw for the  
abutment



**Code:** MUBK3/3003  
**Length\*:** 3.5 mm  
**Diameter:** 4.7 mm  
**Angular:** 30°  
**Includes:** Screw for the  
abutment

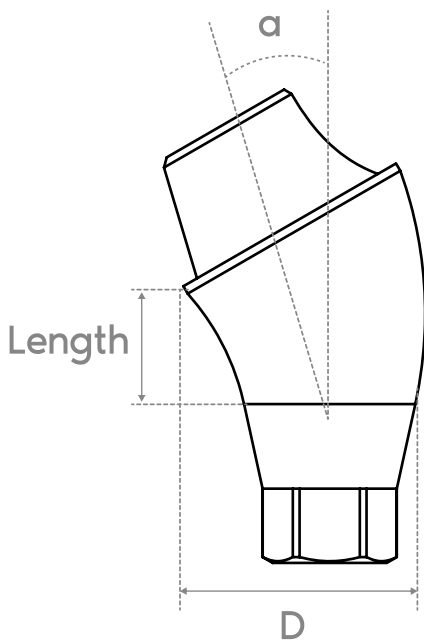

# ANGULATED MULTI-UNITS 45°

## NARROW CONICAL PLATFORM 2.1 MM (3.0)

**Code:** TBMS 4501  
**Length\*:** 1.3 mm  
**Diameter:** 4.3 mm  
**Angular:** 45°  
**Includes:** Screw for the abutment



**Code:** TBMS 4502  
**Length\*:** 2.3 mm  
**Diameter:** 4.3 mm  
**Angular:** 45°  
**Includes:** Screw for the abutment

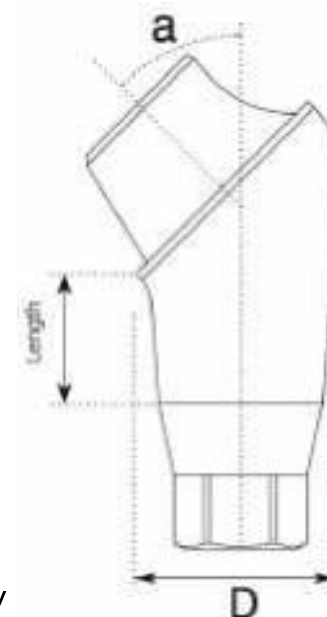
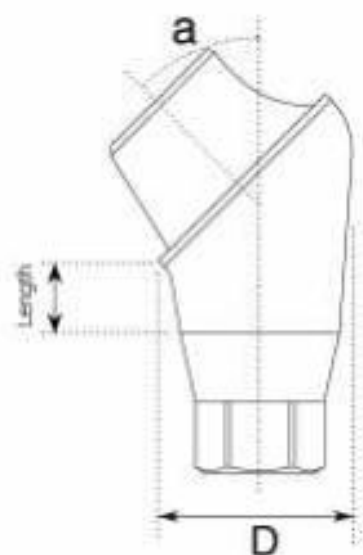

One-piece angular multi-unit 45° conical. Multi-unit system is used for a prosthesis with screw retention. One-piece angular multi-unit allows rehabilitation at non-parallel implants by correcting the angle. The new angular multi-unit is available in 45° option.

# STRAIGHT MULTI-UNITS

Aesthetic abutment (straight multi-unit) with a plastic sleeve is used in order to restore a single structure or a bridge with a screw retention.

Screw in with a maximum force of 40 N.

Indicator includes 0.5 mm of subcortical immersion. For screwing the abutment, please, use adapter for wrench WFI-OS (for Integral implant) page 70

More information about a product you find there

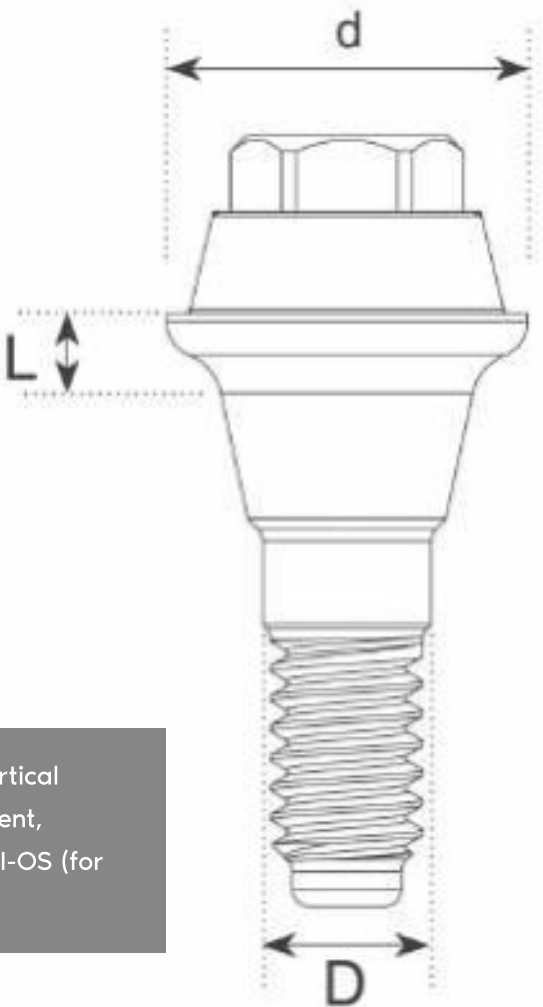
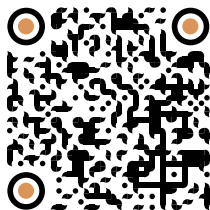

**Code:** AEA3/001+  
**Length\*:** 1.5 mm  
**Diameter (D):** 2.0 mm  
**Diameter (d):** 4.3 mm



**Code:** AEA3/002+  
**Length\*:** 2.5 mm  
**Diameter (D):** 2.0 mm  
**Diameter (d):** 4.3 mm



**Code:** AEA3/003+  
**Length\*:** 3.5 mm  
**Diameter (D):** 2.0 mm  
**Diameter (d):** 4.3 mm

# SLEEVES FOR STRAIGHT AND ANGULAR ROTATIONAL MULTI-UNIT



COBALT-CHROMIUM BASIS

**CCM Base**

for burn out abutment of multi-unit system



PLASTIC SLEEVE

**PMM**



TEMPORARY PEEK  
SLEEVE

**PEMM**



TITANIUM  
SLEEVE

**TSAAM**

# TITANIUM ANTIROTATIONAL ABUTMENTS

## WIDE PLATFORM 2.5 MM (4.2)





**Code:** TAK 3 7

**Length:** 7 mm

**Diameter:** 3.35 mm

**Includes:** Screw for the abutment









**Code:** TAK 3 9

**Length:** 9 mm

**Diameter:** 3.35 mm

**Includes:** Screw for the abutment









**Code:** TAK 3 12

**Length:** 12 mm

**Diameter:** 3.35 mm

**Includes:** Screw for the abutment





# TITANIUM ANTIROTATIONAL WIDE ABUTMENTS

## Wide antirotational titanium conical abutment with hexagon.

Available sizes 9 mm. Mainly used in the area of posterior teeth

**Code:** TAWK 3 9

**Length:** 9 mm

**Diameter:** 5.0 mm

**Includes:** Screw for the abutment









# ANATOMICAL TITANIUM SHOULDER ABUTMENTS

## NARROW CONICAL PLATFORM 2.1 MM (3.0)



**Code:** TAK3/001  
**Length:** 7 mm  
**Length1\*:** 1.5 mm  
**Diameter:** 4.2 mm  
**Includes:** Screw for the abutment



**Code:** TAK3/002  
**Length:** 7 mm  
**Length1\*:** 2.5 mm  
**Diameter:** 4.2 mm  
**Includes:** Screw for the abutment



**Code:** TAK3/003  
**Length:** 7 mm  
**Length1\*:** 3.5 mm  
**Diameter:** 4.2 mm  
**Includes:** Screw for the abutment



**Code:** TAK3/004  
**Length:** 7 mm  
**Length1\*:** 4.5 mm  
**Diameter:** 4.2 mm  
**Includes:** Screw for the abutment

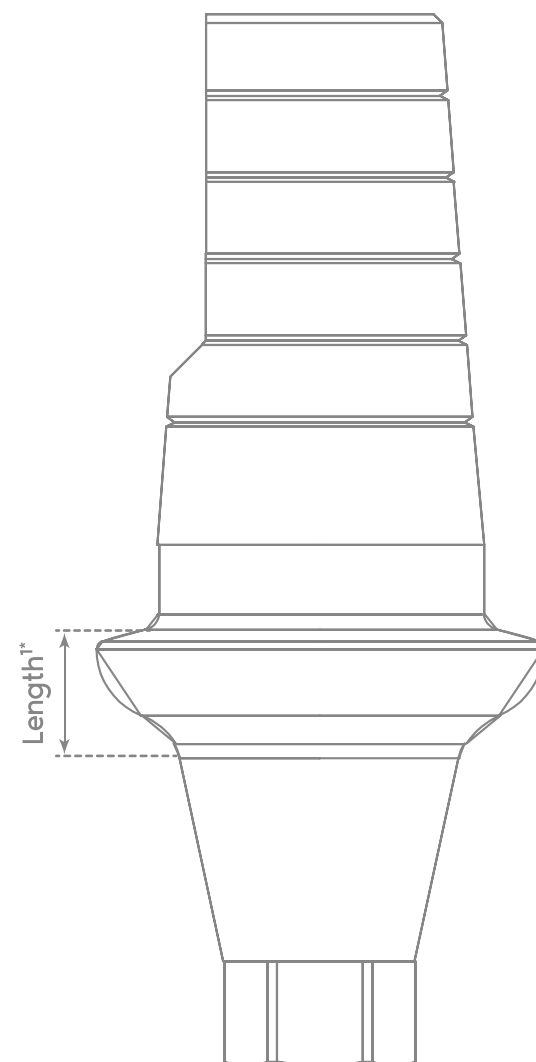

**Anatomical titanium shoulder abutment straight conical.**

Available in three shoulder sizes: 1.5, 2.5, 3.5 mm. \* Indicator includes 0.5 mm of subcortical immersion.

# ANATOMICAL TITANIUM SHOULDER WIDE ABUTMENTS

More information about a  
product you find there



## NARROW CONICAL PLATFORM 2.1 MM (3.0)



**Code:** TAWK3/001  
**Length:** 7.5 mm  
**Length1\*:** 1.5 mm  
**Diameter:** 5.5 mm  
**Includes:** Screw for the  
abutment



**Code:** TAWK3/002  
**Length:** 7.5 mm  
**Length1\*:** 2.5 mm  
**Diameter:** 5.5 mm  
**Includes:** Screw for the  
abutment



**Code:** TAWK3/003  
**Length:** 7.5 mm  
**Length1\*:** 3.5 mm  
**Diameter:** 5.5 mm  
**Includes:** Screw for the  
abutment



**Anatomical titanium shoulder wide abutment straight conical.**

Available in three shoulder sizes: 1.5, 2.5, 3.5 mm. \* Indicator includes 0.5 mm of subcortical immersion.

# ANATOMICAL ANGULAR TITANIUM ABUTMENTS 15°



**Code:** TAAK3/015  
**Length:** 7 mm  
**Angular:** 15°  
**Diameter:** 3.35 mm  
**Includes:** Screw for the abutment

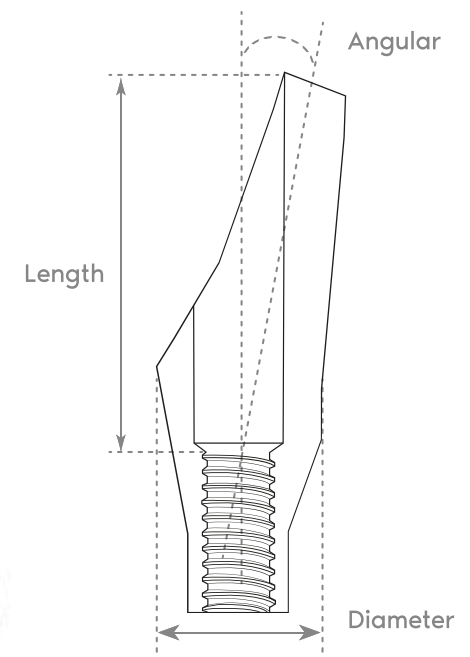

**Angular antirotational titanium conical abutment 15° without a shoulder.**

It is used in cases, when the implant is installed at an angle. This type of the abutment allows creating the aesthetically correct construction with less effort for technician and orthopedist.

## NARROW CONICAL PLATFORM 2.1 MM (3.0)



**Code:** TAAK3/01501  
**Length:** 7 mm  
**Length1\*:** 1.5 mm  
**Angular:** 15°  
**Includes:** Screw for the abutment



**Code:** TAAK3/01502  
**Length:** 7.5 mm  
**Length1\*:** 2.5 mm  
**Angular:** 15°  
**Includes:** Screw for the abutment



**Code:** TAAK3/01503  
**Length:** 7.5 mm  
**Length1\*:** 3.5 mm  
**Angular:** 15°  
**Includes:** Screw for the abutment



WITH SHOULDER 2MM

# ANATOMICAL ANGULAR TITANIUM ABUTMENTS 25°

NARROW CONICAL PLATFORM 2.1 MM (3.0)

**Code:** TAAK3/02502  
**Length:** 7 mm  
**Length1\*:** 2.5 mm  
**Angular:** 25°  
**Includes:** Screw for the  
abutment



WITH SHOULDER 2MM

# ANTIROTATIONAL TITANIUM ANGULAR ABUTMENTS 25°

NARROW CONICAL PLATFORM 2.1 MM (3.0)

**Code:** TAAK3/025  
**Length:** 7 mm  
**Angular:** 25°  
**Diameter:** 3.35 mm  
**Includes:** Screw for the  
abutment



# LOCATORS

Locator with a conical connection is used for removable denture fixation.

A cap made of stainless steel can be included, as well as an intermediate silicone cap. Locator set does not include caps. It can be purchased separately.



## NARROW CONICAL PLATFORM 2.1 MM (3.0)

**Code:** LCK3/2  
**Length:** 2 mm  
**Diameter:** 3.9 mm  
**Diameter inside:** 1.25 mm

**Code:** LCK3/3  
**Length:** 3 mm  
**Diameter:** 3.9 mm  
**Diameter inside:** 1.25 mm

**Code:** LCK3/4  
**Length:** 4 mm  
**Diameter:** 3.9 mm  
**Diameter inside:** 1.25 mm

**Code:** LCK3/5  
**Length:** 5 mm  
**Diameter:** 3.9 mm  
**Diameter inside:** 1.25 mm

**Code:** LCK3/6  
**Length:** 6 mm  
**Diameter:** 3.9 mm  
**Diameter inside:** 1.25 mm

More information about a product you find there

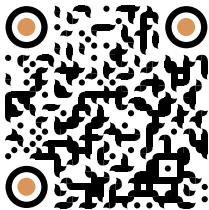



# Removable dental rehabilitation on implants

More information  
about a protocol  
you find there



## CLINICAL AND LABORATORY SURGERY

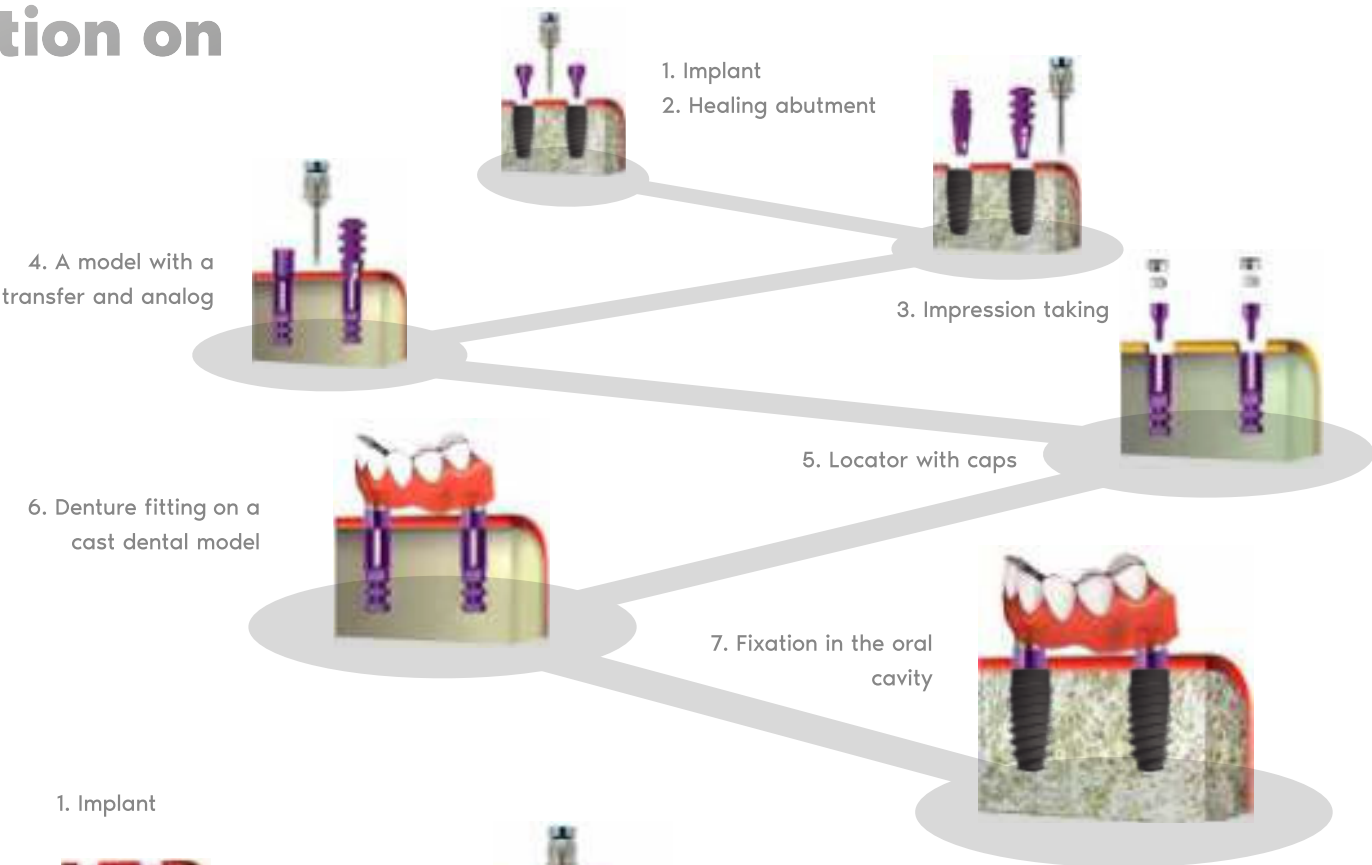

## CLINICAL SURGERIES

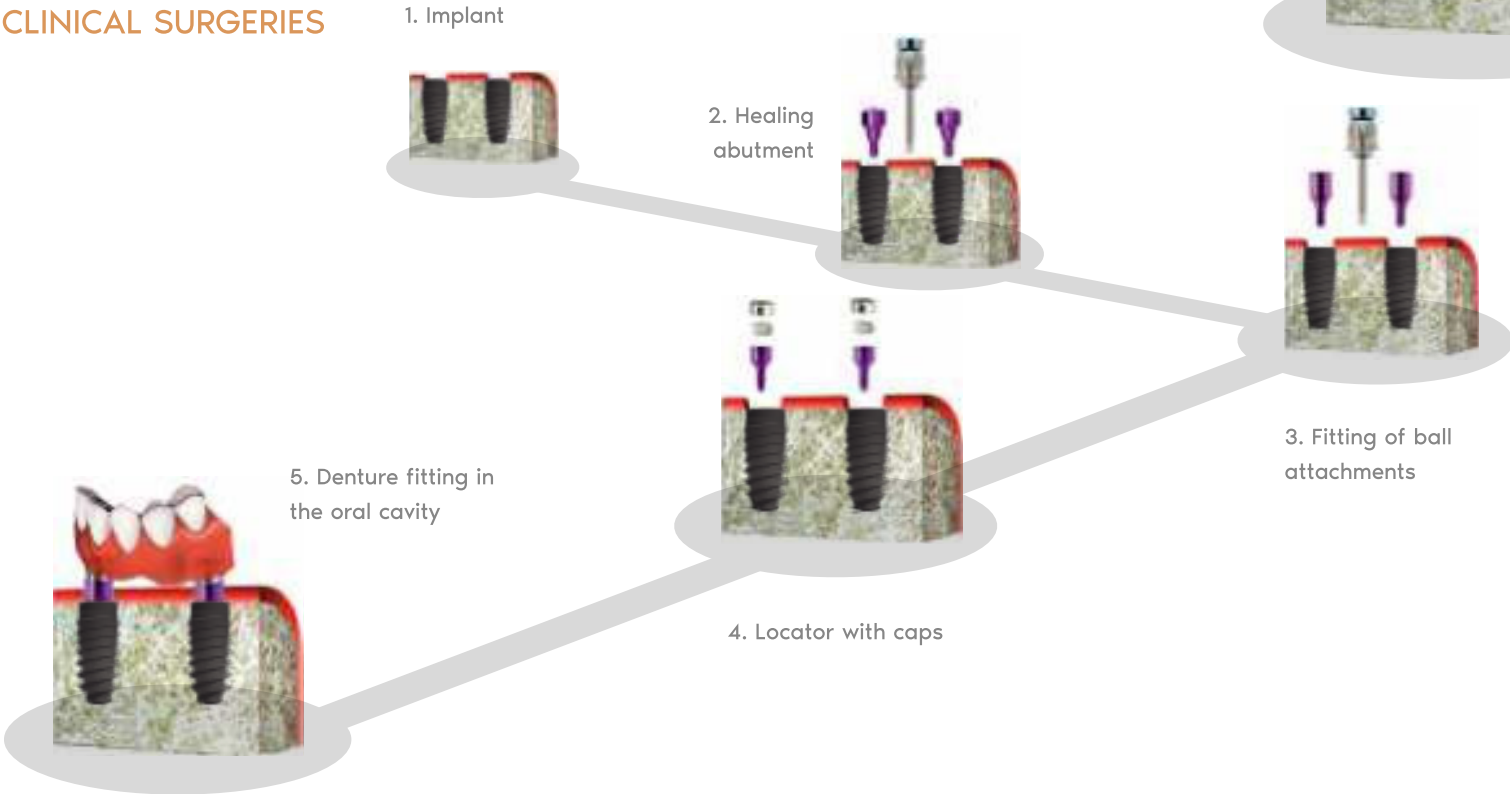

# BALL ATTACHMENTS

A structure with **conical ball attachment** is used for fixation of removable denture. A cap made of stainless steel can be included, as well as an intermediate silicone cap of three different degrees of hardness: soft, standard, and strong. Ball attachment set does not include caps. It can be purchased separately



## NARROW PLATFORM 2.1 MM (3.0)

<b>Code:</b>	BAK3/2	<b>Code:</b>	BAK3/3	<b>Code:</b>	BAK3/4	<b>Code:</b>	BAK3/5
<b>Length:</b>	2 mm	<b>Length:</b>	3 mm	<b>Length:</b>	4 mm	<b>Length:</b>	5 mm
<b>Diameter:</b>	4.2 mm	<b>Diameter:</b>	4.2 mm	<b>Diameter:</b>	4.2 mm	<b>Diameter:</b>	4.2 mm
<b>Diameter cup:</b>	2.5 mm	<b>Diameter cup:</b>	2.5 mm	<b>Diameter cup:</b>	2.5 mm	<b>Diameter cup:</b>	2.5 mm

# Removable dental rehabilitation on implants

More information about a protocol you find there



## CLINICAL SURGERIES

4. A model with a transfer and analog



1. Implant  
2. Healing abutment



3. Impression taking



5. Elements of ball attachment system



6. Denture fitting on a cast dental model

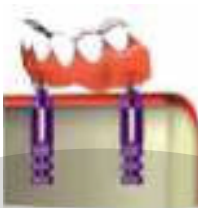

7. Fixation in the oral cavity



## CLINICAL SURGERIES

1. Implant



2. Healing abutment



3. Fitting of ball attachments



4. Silicone and metal inserts



5. Denture fitting in the oral cavity







# HEALING CAPS FOR IMPLANTS

# NARROW CONUS HEALING CAPS

Narrow Konus Healing Cap provides perfect gingival margin. It fits for any following options of dental prosthesis.

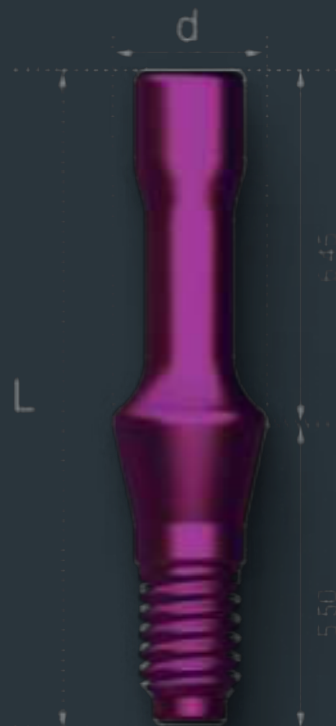

## NARROW PLATFORM 2.1 MM (3.0)

**Code:** SFK3  
**Length (L):** 12 mm  
**Diameter (d):** 2.8 mm

# PEEK HEALING CAPS

PEEK Healing cap provides perfect aesthetics of a gingival margin. It is made of high-quality biologically compatible thermoplastic, which is used for production of medical instruments. PEEK is a perfect material for using in medicine, particularly in dentistry. **It's used for cutomiration of healing of gingiva.**

**Code:** HCPK3  
**Length (L):** 8.95 mm  
**Diameter (d):** 4.2 mm  
**Includes:** Screw for the abutment



HCPK3





# HEALING CAPS FOR STRAIGHT AND ANGULAR MULTI-UNIT

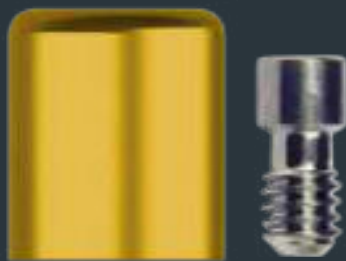

## CAEM

Titanium healing cap for multi-unit is intended to form gingival line and gingival papilla



## HCAEM-W

Titanium healing cap wide for multi-unit is intended to form gingival line and gingival papilla

# HEALING CAPS

Titanium conical healing cap is installed on the implant and is intended to form gingival line and gingival papilla. It is available in following sizes: 2, 3, 4, 5, 7 mm. The size is defined according to the height of gingiva.

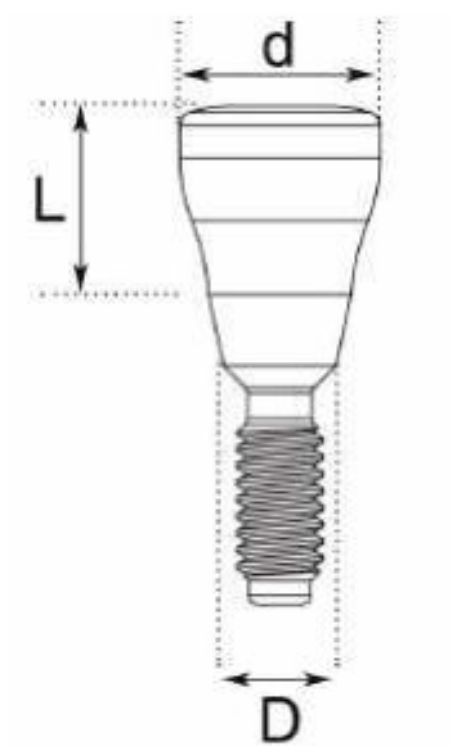

HCK 3/2



HCK 3/3



HCK 3/4



HCK 3/5



HCK 3/7

<b>Code:</b>	HCK 3/2	<b>Code:</b>	HCK 3/3	<b>Code:</b>	HCK 3/4	<b>Code:</b>	HCK 3/5	<b>Code:</b>	HCK 3/7
<b>Length*:</b>	2.5 mm	<b>Length*:</b>	3.5 mm	<b>Length*:</b>	4.5 mm	<b>Length*:</b>	5.5 mm	<b>Length*:</b>	7.5 mm
<b>Diameter:</b>	4.2 mm	<b>Diameter:</b>	4.2 mm	<b>Diameter:</b>	4.2 mm	<b>Diameter:</b>	4.2 mm	<b>Diameter:</b>	4.2 mm
<b>Diameter</b>	2.35	<b>Diameter</b>	2.35	<b>Diameter</b>	2.35	<b>Diameter</b>	2.35	<b>Diameter</b>	2.35
<b>inside:</b>	mm	<b>inside:</b>	mm	<b>inside:</b>	mm	<b>inside:</b>	mm	<b>inside:</b>	mm



More information about a  
product you find there

# WIDE HEALING CAPS



<b>Code:</b>	HCWK 3/2	<b>Code:</b>	HCWK 3/3	<b>Code:</b>	HCWK 3/4	<b>Code:</b>	HCWK 3/5	<b>Code:</b>	HCWK 3/7
<b>Length*:</b>	2.5 mm	<b>Length*:</b>	3.5 mm	<b>Length*:</b>	4.5 mm	<b>Length*:</b>	5.5 mm	<b>Length*:</b>	7.5 mm
<b>Diameter:</b>	5.5 mm	<b>Diameter:</b>	5.5 mm	<b>Diameter:</b>	5.5 mm	<b>Diameter:</b>	5.5 mm	<b>Diameter:</b>	5.5 mm
<b>Diameter inside:</b>	2.35 mm	<b>Diameter inside:</b>	2.35 mm	<b>Diameter inside:</b>	2.35 mm	<b>Diameter inside:</b>	2.35 mm	<b>Diameter inside:</b>	2.35 mm

# EXTRA WIDE HEALING CAPS

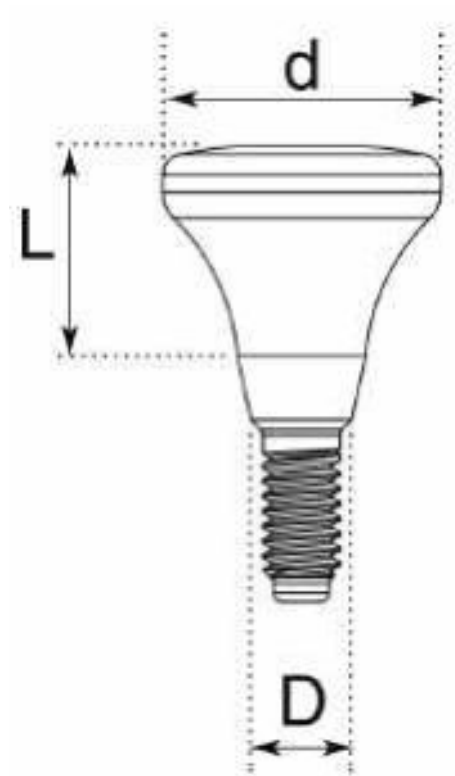

**Code:** HCWK 6.5/3  
**Length\*:** 3.5 mm  
**Diameter:** 6.5 mm  
**Diameter** 2.35 mm  
**inside:**

**Code:** HCWK 6.5/4  
**Length\*:** 4.5 mm  
**Diameter:** 6.5 mm  
**Diameter** 2.35 mm  
**inside:**

**Code:** HCWK 6.5/5  
**Length\*:** 5.5 mm  
**Diameter:** 6.5 mm  
**Diameter** 2.35 mm  
**inside:**

**Code:** HCWK 6.5/7  
**Length\*:** 7.5 mm  
**Diameter:** 6.5 mm  
**Diameter** 2.35 mm  
**inside:**

\* – Indicator includes 0.5 mm of subcortical immersion.

HCWK 8.0/3



HCWK 8.0/4



HCWK 8.0/5



HCWK 8.0/7



**Code:** HCWK 8.0/3  
**Length(L)\*:** 3.5 mm  
**Diameter(d):** 8 mm  
**Diameter (D):** 2.35 mm

**Code:** HCWK 8.0/4  
**Length(L)\*:** 4.5 mm  
**Diameter(d):** 8 mm  
**Diameter (D):** 2.35 mm

**Code:** HCWK 8.0/5  
**Length(L)\*:** 5.5 mm  
**Diameter(d):** 8 mm  
**Diameter (D):** 2.35 mm

**Code:** HCWK 8.0/7  
**Length(L)\*:** 7.5 mm  
**Diameter(d):** 8 mm  
**Diameter (D):** 2.35 mm

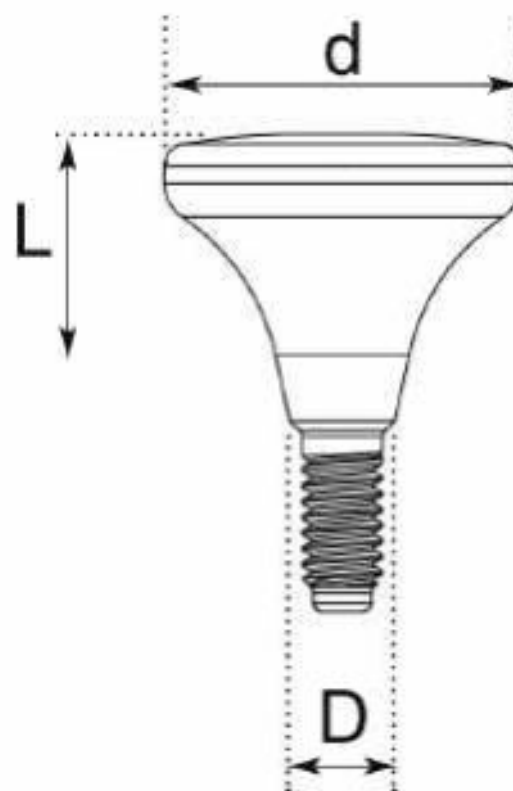







# TRANSFERS & ANALOGS FOR IMPLANTS. SCAN-ABUTMENTS



CONICAL

# SCAN-ABUTMENTS

**Code:** ATN9  
**Length:** 14 mm  
**Diameter:** 3.5 mm  
**Includes:** Screw for the abutment

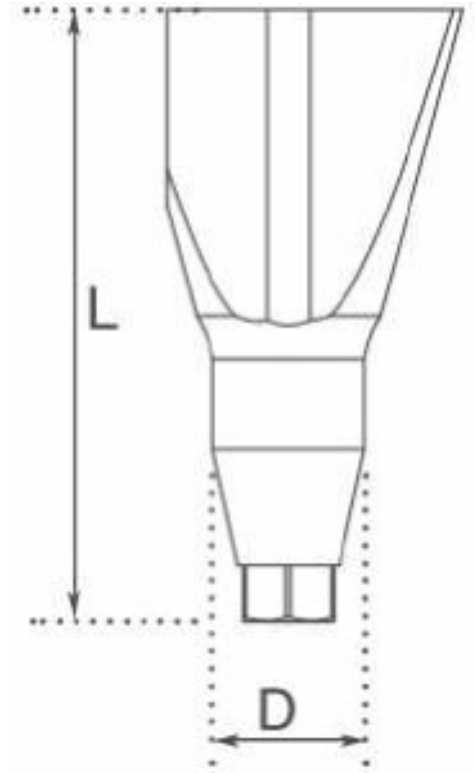

## NARROW SCAN-ABUTMENTS

**Code:** ATN9-Ti  
**Length:** 10.5 mm  
**Diameter:** 3.5 mm  
**Includes:** Screw for the abutment



CONICAL

# DIGITAL ANALOGS



**D-ANK3**

MULTI-UNIT

# DIGITAL ANALOGS



**D-ANAEM**



**AT-MU**

SCAN ABUTMENT FOR MU

CONICAL

# CLOSED TRAY TRANSFERS

The length of conical closed tray transfer is 13.75 mm.

It is used in closed tray impression coping.

**Code:** TCK3/9  
**Length (L):** 13.75 mm  
**Diameter (D):** 3 mm  
**Diameter (d):** 4.2 mm  
**Includes:** Retaining

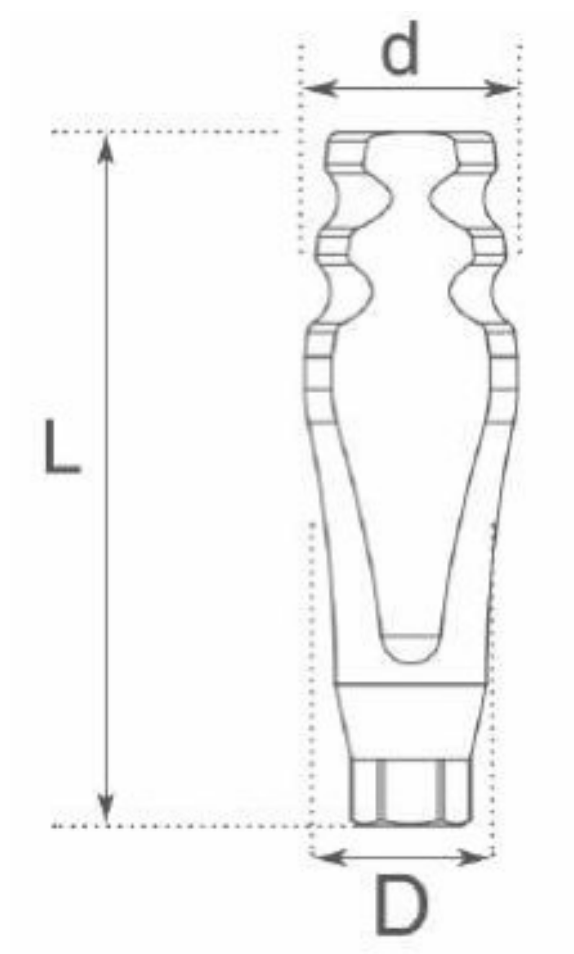

CONICAL

# OPEN TRAY TRANSFERS



**Code:** TCK3/13  
**Length (L):** 12.5 mm  
**Diameter (d):** 5 mm  
**Includes:** Retaining



**Code:** TCK3/15  
**Length (L):** 17.85 mm  
**Diameter (d):** 5 mm  
**Includes:** Retaining



CONICAL

# IMPLANT ANALOGS

It is used as an implant analog in the dental laboratory. It allows to prepare laboratory models

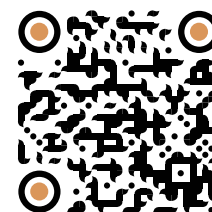

More information about a product you find there

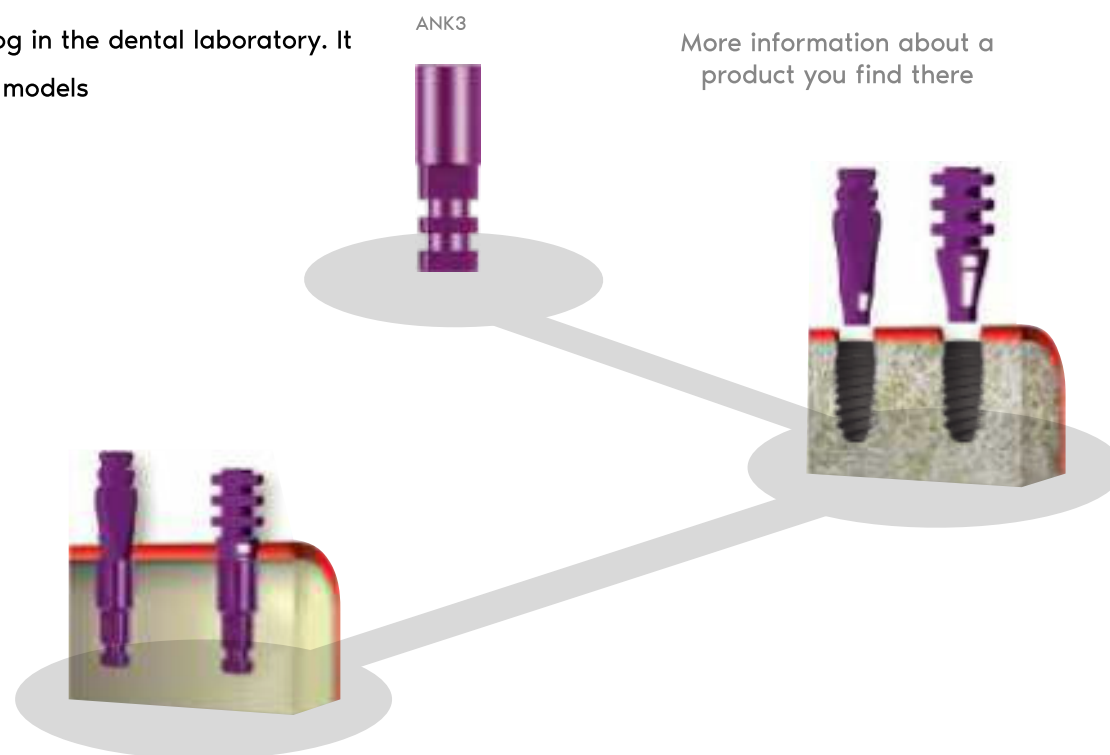

# TRANSFERS

FOR ANGULAR AND STRAIGHT (ROTATIONAL) MULTI-UNIT 17°/30°

Open tray transfer for multi-unit with a size of 10 mm. It is used in open tray impression coping.

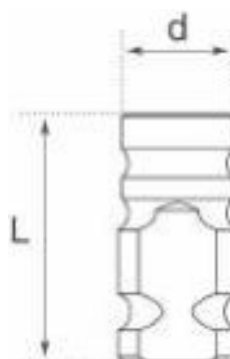

**Code:** TCAEM  
**Length (L):** 10 mm  
**Diameter (d):** 4.5 mm



# ANALOGS

FOR ANGULAR AND STRAIGHT  
(ROTATIONAL) MULTI-UNIT 17°/30°

It is used as an implant analog with multi-unit in the dental laboratory. It allows preparing laboratory models.

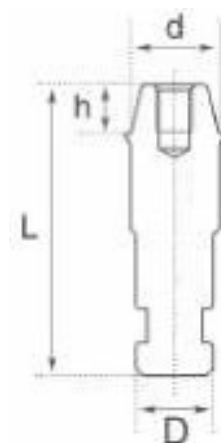

<b>Code:</b>	ANAEM
<b>Length (L):</b>	12.4 mm
<b>Diameter (D):</b>	3.3 mm
<b>Diameter (d):</b>	3.75 mm
<b>Height (h):</b>	2.0 mm

# OPEN TRAY TRANSFERS

FOR ANTIROTATIONAL STRAIGHT MULTI-UNIT

Open tray transfer for aesthetic antirotational abutment (straight multi-unit) with a size of 10 mm. It is used in open tray impression coping.

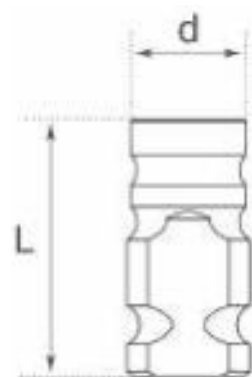

<b>Code:</b>	TCAEK
<b>Length (L):</b>	10 mm
<b>Diameter (d):</b>	4.8 mm

# ANALOGS OF AN IMPLANT

WITH AN ANTIROTATION STRAIGHT MULTI-UNIT

It serves as an analog of an implant with an aesthetic antirotation abutment (straight multi-unit) in the dental technical lab. Allows preparing laboratory models.

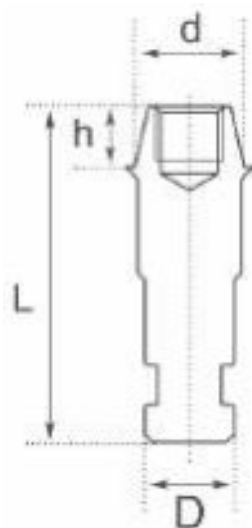

<b>Code:</b>	ANAEK
<b>Length (L):</b>	12.4 mm
<b>Diameter (D):</b>	3.3 mm
<b>Diameter (d):</b>	4.0 mm
<b>Height (h):</b>	2.0 mm





NARROW CONICAL PLATFORM 2.1 MM (3.0)

# IMPLANT DRIVERS FOR IMPLANTS WITH CONICAL CONNECTION



IDK3/9



IDK3/18

**FOR TORQUE  
RATCHET /  
TORQUE  
CONTROL  
WRENCH**



DA

**ADAPTER FOR  
IMPLANT  
DRIVERS**

Implant driver adapter for  
surgical handpiece for:

- torque ratchet
- torque control wrench



HPIDK 3/9



HPIDK 3/18

**FOR SURGICAL  
HANDPIECE**



HDS9

HDS18

### 9 mm and 18 mm size

Short and long manual wrench for bone screws. It can be used for manual screw fixation, as well as for torque ratchet or torque control wrench. It can be used with all screws in the system

## UNIVERSAL WRENCH FOR ABUTMENT SCREW FIXATION

# INSTRUMENTS



GF-BP

## GUIDE SCREW



BP-4.6



BP-5.8

## BONE PROFILER



G5/TP5.0

## TISSUE PUNCH



GS-D5-h3.5-S

Drill Guide D5 mm,  
x3.5



GS-D5.0-S

Drill Guide  
D5 mm



GS-D5

Drill Guide D5  
mm



GS-D5 h4

Drill Guide D5  
mm, x4



GS-D2.0

Drill Guide  
D2.0 mm



DS-H1



DS-H1.5

## DRILL STOPPERS



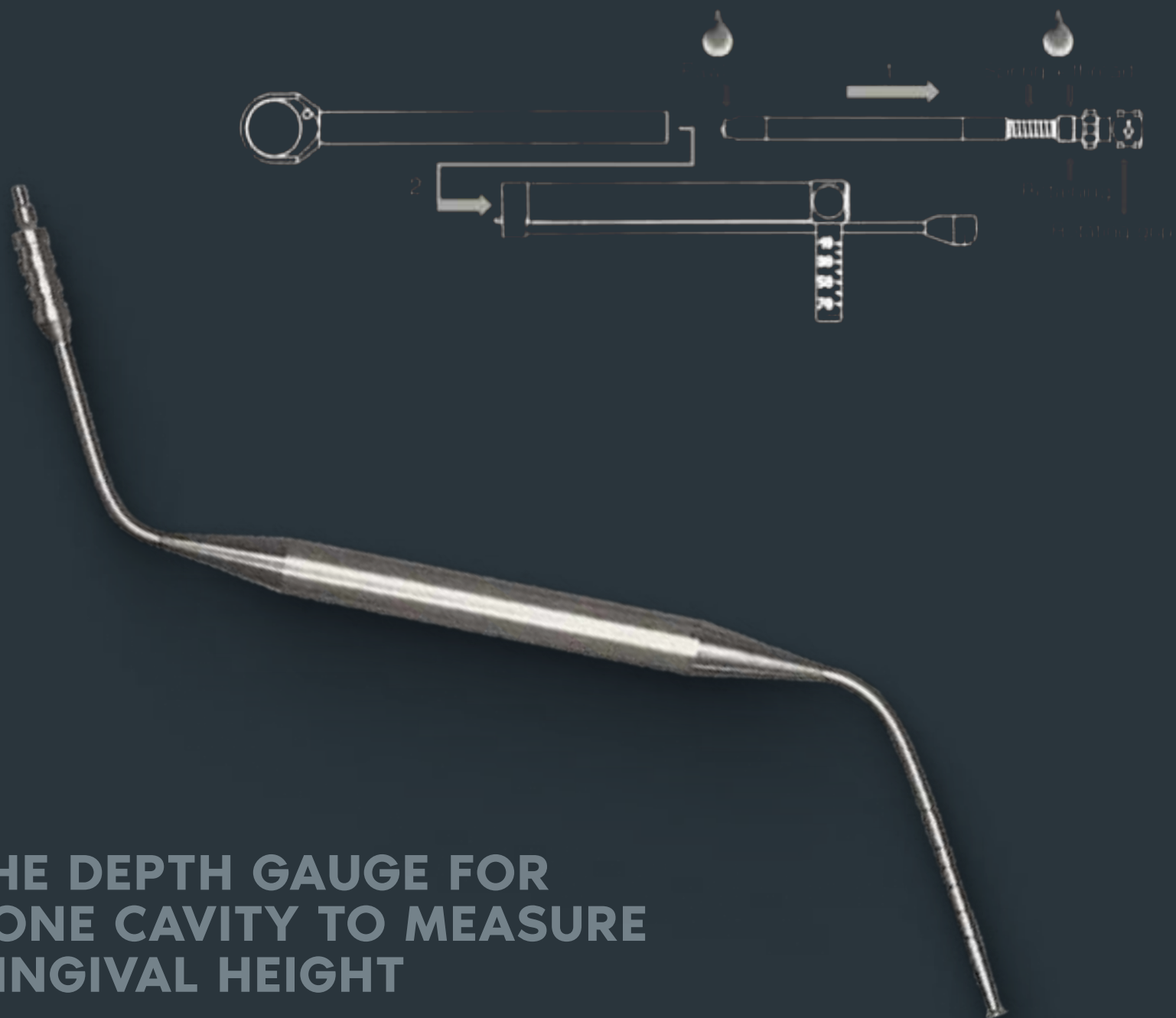

DM

## THE DEPTH GAUGE FOR BONE CAVITY TO MEASURE GINGIVAL HEIGHT

# DRILLS

## DIAMOND COATED DRILLS

Perfect formation of a bone cavity for installation of conical shape implant: Active Bio, Active Konus. Conical shape of drill perfectly recreates the shape of conical implant without thread. Diamond like coating allows maintaining the cutting properties of a drill for a longer period of time.



TCA 1.5



TCA 2.0



TCA 2.8



TCA 3.0



TCA 3.45



TCA 3.9

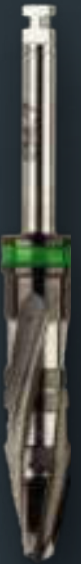

TCA 4.7

**MARKING  
DRILL**

**DIAMOND LIKE  
COATING. PILOT  
DRILL**

**DIAMOND LIKE COATING.  
PILOT DRILL**

# COUNTERSINKS

It is used in order to reduce compression in cortical layer, to preserve trophicity, and to prevent bone resorption



TDCS3.2



TDCS3.75



TDCS4.2



TDCS5

The image shows a dental handpiece tray with the following components and labels:

- TORQUE ADAPTOR**: A long metal tool with a handle and a chuck.
- COUNTERSINKS**: A row of six different sized countersinks labeled Ø1.8, Ø2.0, Ø2.8, Ø3.0, Ø3.45, Ø3.9, and Ø4.7.
- DRILL EXPANDER**: A row of four different sized drill expanders labeled 3.2, 3.75, 4.2, and 5.0.
- PARALLEL**: A row of four different sized parallel tools labeled 3.2, 3.75, 4.2, and 5.0.
- HAND PIECE**: A row of four different sized hand pieces labeled 3.2, 3.75, 4.2, and 5.0.
- SPARES**: A row of four different sized spares labeled 3.2, 3.75, 4.2, and 5.0.
- DRIVER ADAPTOR**: A row of four different sized driver adaptors labeled 3.2, 3.75, 4.2, and 5.0.
- PRE-DRILL**: A row of four different sized pre-drills labeled 3.2, 3.75, 4.2, and 5.0.
- DRILL STOPS**: A row of four different sized drill stops labeled 3.2, 3.75, 4.2, and 5.0.
- IMPLANT DRIVERS**: A row of four different sized implant drivers labeled 3.2, 3.75, 4.2, and 5.0.
- PINS**: A row of four different sized pins labeled 3.2, 3.75, 4.2, and 5.0.
- RATCHET ADAPTORS**: A row of four different sized ratchet adaptors labeled 3.2, 3.75, 4.2, and 5.0.

66 / 69

# DRILL



DIAMOND LIKE COATING. PILOT DRILLS

DIAMOND LIKE COATING. TAPERED FINISHING



TD-E  
DRILL EXTENSION



DIRECTION INDICATOR, DEPTH GAUGE

# COUNTERSINKS



# IMPLANT DRIVERS



# STOPPERS



ADAPTER FOR IMPLANT DRIVERS

FOR 2.8 DRILLS AND 2.0

FOR TCA 3.0, 3.45, 3.9, 4.7 DRILLS





PT-1.5

**FIXATION  
PIN**



PD-1.5

**DRILL  
FOR  
FIXATION  
PIN**



MP Konus 3-HP



MP Konus 3\_3

**MOUNTER  
PLATFORM**



ADS Hex 4

**RATCHET  
ADAPTOR**



ADL Hex 4



SE 1.72

**EXTRACTOR**



G5/TP5.0

**TISSUE  
PUNCH**



MD Hex.3

**HANDPIECE  
ADAPTER**



GBM 4.8

**BONE  
MILL**



# DRILL

GD-1.  
9/8    GD-1.9  
/10    GD-1.9  
/15    GD-1.9  
/13    GD-1.9  
/16



GD-2.  
8/8    GD-2.8  
/10    GD-2.8  
/11.5    GD-2.8  
/13    GD-2.8  
/16



GD-3.  
2/8    GD-3.2  
/10    GD-3.2  
/15    GD-3.2  
/13    GD-3.2  
/16



GD-3.  
6/8    GD-3.6  
/10    GD-3.6  
/11.5    GD-3.6  
/13    GD-3.6  
/16



GD-4.  
0/8    GD-4.0  
/10    GD-4.0  
/15    GD-4.0  
/13    GD-4.0  
/16



GD-4.  
8/8    GD-4.  
8/10    GD-4.  
8/11.5    GD-4.  
8/13    GD-4.  
8/16



# MOUNTER PLATFORM



MP Konus  
3+    MP Konus  
3+2    MP Konus  
3+4    MP Konus  
3+6



RR  
**TORQUE RATCHET**



HDS9    HDS18

**UNIVERSAL WRENCH  
FOR ABUTMENT  
SCREW FIXATION**



RT10-45  
**TORQUE CONTROL WRENCH**

## CELL IMPLANT

# NOTES

[illegible][illegible]

